

Инструмент для сверления отверстий

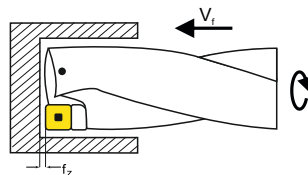

Справочная информация

Частота вращения	$n = \frac{v_c \times 1000}{D_c \times \pi} \text{ [min}^{-1}\text{]}$
Скорость резания	$v_c = \frac{D_c \times \pi \times n}{1000} \text{ [m/min]}$
Подача на оборот	$f = f_z \times z \text{ [mm]}$
Подача	$v_f = f \times n \text{ [mm/min]}$
Крутящий момент	$M_c = \frac{D_c^2 \times k_c \times f}{8000} = \frac{P_c \times 9500}{n} \text{ [Nm]}$
Мощность	$P_{mot} = \frac{Q \times k_c}{60000 \times \eta} \text{ [kW]}$



n	Частота вращения	об/мин
D_c	Рабочий диаметр сверла	мм
z	Число зубьев	
v_c	Скорость резания	м/мин
v_f	Подача	мм/мин
f_z	Подача на зуб	мм
f	Подача на оборот	мм
P_{mot}	Потребляемая мощность	кВт
M_c	Крутящий момент	Нм
k_c	Удельная сила резания	Н/мм ²
η	КПД станка (0,7–0,95)	

Общие рекомендации:

Высокая точность обработки обеспечивается за счет:

- точного базирования сверла;
- жесткого закрепления сверла (рабочая часть не должна являться базой закрепления);
- достаточной подачи СОЖ в зону резания;
- жесткости закрепления и точности установки заготовки.

Максимально допустимое биение инструмента не более 0,2 мм;

Режимы резания Right Way

Сплав	Сталь >HRC		Сталь 25-35HRC		Нержавеющая сталь		Чугун		Цветные сплавы		Жаропрочные сплавы	
	$V_c = \text{m/min}$	$f = \text{mm/rev}$	$V_c = \text{m/min}$	$f = \text{mm/rev}$	$V_c = \text{m/min}$	$f = \text{mm/rev}$	$V_c = \text{m/min}$	$f = \text{mm/rev}$	$V_c = \text{m/min}$	$f = \text{mm/rev}$	$V_c = \text{m/min}$	$f = \text{mm/rev}$
3015	80-150	0.05-0.20	30-100	0.05-0.12	70-120	0.05-0.12	80-150	0.05-0.20	120-300	0.05-0.30	20-60	0.05-0.30
3007	60-120	0.05-0.20	20-80	0.05-0.12	50-100	0.05-0.12	50-100	0.05-0.20	80-250	0.05-0.30	20-40	0.05-0.30

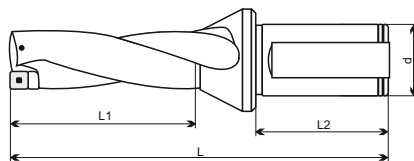

Модель	L1	L2	L	D	d	Применяемая пластина	Винт	Ключ
ZD02-13. 0-XP25-SP05-02	31	56	104	13	25	SPMG050204	M2X5	T6
ZD02-14. 0-XP25-SP05-02	33	56	106	14				
ZD02-15. 0-XP25-SP05-02	35	56	108	15				
ZD02-16. 0-XP25-SP06-02	37	56	110	16				
ZD02-17. 0-XP25-SP06-02	39	56	112	17				
ZD02-18. 0-XP25-SP06-02	41	56	114	18				
ZD02-19. 0-XP25-SP06-02	43	56	116	19				
ZD02-20. 0-XP25-SP06-02	45	56	119	20		SPMG060204	M2. 2X5	T6
ZD02-21. 0-XP25-SP06-02	47	56	121	21				
ZD02-22. 0-XP25-SP07-02	49	56	123	22				
ZD02-23. 0-XP25-SP07-02	51	56	125	23				
ZD02-24. 0-XP25-SP07-02	53	56	127	24				
ZD02-25. 0-XP32-SP07-02	55	60	141	25				
ZD02-26. 0-XP32-SP07-02	57	60	143	26				
ZD02-27. 0-XP32-SP07-02	59	60	145	27	SPMG07T308	M2. 5X6	T8	
ZD02-28. 0-XP32-SP09-02	61	60	147	28				
ZD02-29. 0-XP32-SP09-02	63	60	149	29				
ZD02-30. 0-XP32-SP09-02	65	60	151	30				
ZD02-31. 0-XP32-SP09-02	67	60	153	31				
ZD02-32. 0-XP32-SP09-02	69	60	155	32				
ZD02-33. 0-XP32-SP09-02	71	60	157	33				
ZD02-34. 0-XP32-SP11-02	73	60	159	34	32	SPMG090408	M3. 5X8	T15
ZD02-35. 0-XP32-SP11-02	75	60	161	35				
ZD02-36. 0-XP32-SP11-02	77	60	163	36				
ZD02-37. 0-XP32-SP11-02	79	60	165	37				
ZD02-38. 0-XP32-SP11-02	81	60	167	38				
ZD02-39. 0-XP32-SP11-02	83	60	169	39				
ZD02-40. 0-XP32-SP11-02	85	60	171	40				
ZD02-41. 0-XP32-SP14-02	87	60	173	41	40	SPMG140512	M5X10	T20
ZD02-42. 0-XP32-SP14-02	89	60	175	42				
ZD02-43. 0-XP40-SP14-02	91	65	186	43				
ZD02-44. 0-XP40-SP14-02	93	65	188	44				
ZD02-45. 0-XP40-SP14-02	95	65	190	45				
ZD02-46. 0-XP40-SP14-02	97	65	192	46				
ZD02-47. 0-XP40-SP14-02	99	65	194	47				
ZD02-48. 0-XP40-SP07-04	101	65	196	48	SPMG07T308	M2. 5X6	T8	
ZD02-49. 0-XP40-SP07-04	103	65	198	49				
ZD02-50. 0-XP40-SP07-04	105	65	200	50				
ZD02-51. 0-XP40-SP07-04	107	65	202	51				
ZD02-52. 0-XP40-SP09-04	109	65	204	52				
ZD02-53. 0-XP40-SP09-04	111	65	206	53				
ZD02-54. 0-XP40-SP09-04	113	65	208	54				
ZD02-55. 0-XP40-SP09-04	115	65	210	55	SPMG090408	M3. 5X8	T15	
ZD02-56. 0-XP40-SP09-04	117	65	212	56				
ZD02-57. 0-XP40-SP09-04	119	65	214	57				
ZD02-58. 0-XP40-SP09-04	121	65	216	58				
ZD02-59. 0-XP40-SP09-04	123	65	218	59				
ZD02-60. 0-XP40-SP09-04	125	65	220	60				

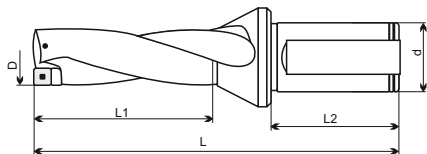

Модель	L1	L2	L	D	d	Применяемая пластина	Винт	Ключ
ZD03-13. 0-XP25-SP05-02	44	56	117	13	25	SPMG050204	M2X5	T6
ZD03-13. 5-XP25-SP05-02	45.5	56	118	13.5				
ZD03-14. 0-XP25-SP05-02	47	56	120	14				
ZD03-14. 5-XP25-SP05-02	48.5	56	122	14.5				
ZD03-15. 0-XP25-SP05-02	50	56	123	15				
ZD03-15. 5-XP25-SP06-02	51.5	56	124	15.5				
ZD03-16. 0-XP25-SP06-02	53	56	126	16				
ZD03-16. 5-XP25-SP06-02	54.5	56	127	16.5				
ZD03-17. 0-XP25-SP06-02	56	56	129	17				
ZD03-17. 5-XP25-SP06-02	57.5	56	130	17.5				
ZD03-18. 0-XP25-SP06-02	59	56	132	18				
ZD03-18. 5-XP25-SP06-02	60.5	56	133	18.5				
ZD03-19. 0-XP25-SP06-02	62	56	135	19				
ZD03-19. 5-XP25-SP06-02	63.5	56	136	19.5				
ZD03-20. 0-XP25-SP06-02	65	56	139	20				
ZD03-20. 5-XP25-SP06-02	66.5	56	140	20.5				
ZD03-21. 0-XP25-SP06-02	68	56	142	21				
ZD03-21. 5-XP25-SP06-02	69.5	56	143	21.5				
ZD03-22. 0-XP25-SP07-02	71	56	145	22				
ZD03-22. 5-XP25-SP07-02	72.5	56	148	22.5				
ZD03-23. 0-XP25-SP07-02	74	56	148	23				
ZD03-23. 5-XP25-SP07-02	75.5	56	149	23.5				
ZD03-24. 0-XP25-SP07-02	77	56	151	24				
ZD03-24. 5-XP25-SP07-02	78.5	56	152	24.5				
ZD03-25. 0-XP32-SP07-02	80	60	166	25				
ZD03-25. 5-XP32-SP07-02	81.5	60	167	25.5				
ZD03-26. 0-XP32-SP07-02	83	60	169	26				
ZD03-26. 5-XP32-SP07-02	84.5	60	170	26.5				
ZD03-27. 0-XP32-SP07-02	86	60	172	27				
ZD03-27. 5-XP32-SP07-02	87.5	60	173	27.5				
ZD03-28. 0-XP32-SP09-02	89	60	175	28				
ZD03-28. 5-XP32-SP09-02	90.5	60	176	28.5				
ZD03-29. 0-XP32-SP09-02	92	60	178	29				
ZD03-29. 5-XP32-SP09-02	93.5	60	179	29.5				
ZD03-30. 0-XP32-SP09-02	95	60	181	30				
ZD03-30. 5-XP32-SP09-02	96.5	60	182	30.5				
ZD03-31. 0-XP32-SP09-02	98	60	184	31				
ZD03-31. 5-XP32-SP09-02	99.5	60	185	31.5				
ZD03-32. 0-XP32-SP09-02	101	60	187	32				
ZD03-32. 5-XP32-SP09-02	102.5	60	188	32.5				
ZD03-33. 0-XP32-SP09-02	104	60	190	33				
ZD03-33. 5-XP32-SP09-02	105.5	60	191	33.5				
					32	SPMG090408	M3. 5X8	T15

Модель	L1	L2	L	D	d	Применяемая пластина	Винт	Ключ
ZD03-34.0-XP32-SP11-02	107	60	193	34	32	SPMG110408	M4X10	T15
ZD03-34.5-XP32-SP11-02	108.5	60	194	34.5				
ZD03-35.0-XP32-SP11-02	110	60	196	35				
ZD03-35.5-XP32-SP11-02	111.5	60	197	35.5				
ZD03-36.0-XP32-SP11-02	113	60	199	36				
ZD03-36.5-XP32-SP11-02	114.5	60	200	36.5				
ZD03-37.0-XP32-SP11-02	116	60	202	37				
ZD03-37.5-XP32-SP11-02	117.5	60	203	37.5				
ZD03-38.0-XP32-SP11-02	119	60	205	38				
ZD03-38.5-XP32-SP11-02	120.5	60	206	38.5				
ZD03-39.0-XP32-SP11-02	122	60	206	39				
ZD03-39.5-XP32-SP11-02	123.5	60	209	39.5				
ZD03-40.0-XP32-SP11-02	125	60	211	40				
ZD03-41.0-XP32-SP14-02	128	60	214	41				
ZD03-42.0-XP32-SP14-02	131	60	217	42				
ZD03-43.0-XP40-SP14-02	134	65	229	43				
ZD03-44.0-XP40-SP14-02	137	65	232	44				
ZD03-45.0-XP40-SP14-02	140	65	235	45				
ZD03-46.0-XP40-SP14-02	143	65	238	46				
ZD03-47.0-XP40-SP14-02	146	65	241	47				
ZD03-48.0-XP40-SP07-04	149	65	244	48				
ZD03-49.0-XP40-SP07-04	152	65	247	49				
ZD03-50.0-XP40-SP07-04	155	65	250	50				
ZD03-51.0-XP40-SP07-04	158	65	253	51	SPMG07T308	M2. 5X6	T8	
ZD03-52.0-XP40-SP09-04	161	65	256	52				
ZD03-53.0-XP40-SP09-04	164	65	259	53				
ZD03-54.0-XP40-SP09-04	167	65	262	54				
ZD03-55.0-XP40-SP09-04	170	65	265	55				
ZD03-56.0-XP40-SP09-04	173	65	268	56				
ZD03-57.0-XP40-SP09-04	176	65	271	57				
ZD03-58.0-XP40-SP09-04	179	65	274	58				
ZD03-59.0-XP40-SP09-04	182	65	277	59				
ZD03-60.0-XP40-SP09-04	185	65	280	60				SPMG090408

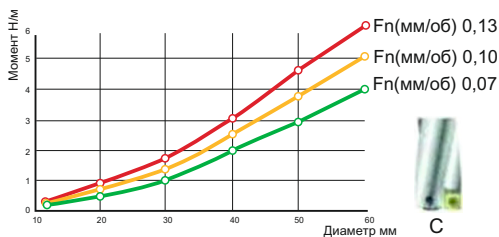
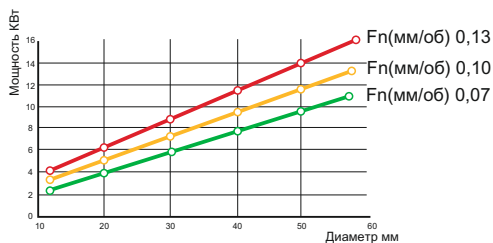

C

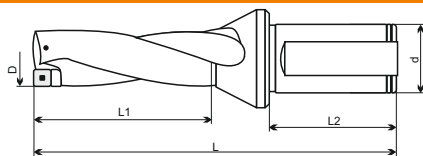

Модель	L1	L2	L	D	d	Применяемая пластина	Винт	Ключ
ZD04-13. 0-XP25-SP05-02	57	56	130	13	25	SPMG050204	M2X5	T6
ZD04-13. 5-XP25-SP05-02	59	56	132	13.5				
ZD04-14. 0-XP25-SP05-02	61	56	134	14				
ZD04-14. 5-XP25-SP05-02	63	56	136	14.5				
ZD04-15. 0-XP25-SP05-02	65	56	138	15				
ZD04-15. 5-XP25-SP06-02	67	56	140	15.5				
ZD04-16. 0-XP25-SP06-02	69	56	142	16				
ZD04-16. 5-XP25-SP06-02	71	56	144	16.5				
ZD04-17. 0-XP25-SP06-02	73	56	146	17				
ZD04-17. 5-XP25-SP06-02	75	56	148	17.5				
ZD04-18. 0-XP25-SP06-02	77	56	150	18				
ZD04-18. 5-XP25-SP06-02	79	56	152	18.5				
ZD04-19. 0-XP25-SP06-02	81	56	154	19				
ZD04-19. 5-XP25-SP06-02	83	56	155	19.5				
ZD04-20. 0-XP25-SP06-02	85	56	159	20				
ZD04-20. 5-XP25-SP06-02	87	56	161	20.5				
ZD04-21. 0-XP25-SP06-02	89	56	163	21				
ZD04-21. 5-XP25-SP06-02	91	56	165	21.5				
ZD04-22. 0-XP25-SP07-02	93	56	167	22				
ZD04-22. 5-XP25-SP07-02	95	56	169	22.5				
ZD04-23. 0-XP25-SP07-02	97	56	171	23				
ZD04-23. 5-XP25-SP07-02	99	56	173	23.5				
ZD04-24. 0-XP25-SP07-02	101	56	175	24				
ZD04-24. 5-XP25-SP07-02	103	56	177	24.5				
ZD04-25. 0-XP32-SP07-02	105	60	191	25	32	SPMG07T308	12. 5X6	T8
ZD04-25. 5-XP32-SP07-02	107	60	193	25.5				
ZD04-26. 0-XP32-SP07-02	109	60	195	26				
ZD04-26. 5-XP32-SP07-02	111	60	197	26.5				
ZD04-27. 0-XP32-SP07-02	113	60	199	27				
ZD04-27. 5-XP32-SP07-02	115	60	201	27.5				
ZD04-28. 0-XP32-SP09-02	117	60	203	28				
ZD04-28. 5-XP32-SP09-02	119	60	205	28.5				
ZD04-29. 0-XP32-SP09-02	121	60	207	29				
ZD04-29. 5-XP32-SP09-02	123	60	209	29.5				
ZD04-30. 0-XP32-SP09-02	125	60	211	30				
ZD04-30. 5-XP32-SP09-02	127	60	213	30.5	SPMG090408	ИЗ. 5X8	T15	
ZD04-31. 0-XP32-SP09-02	129	60	215	31				
ZD04-31. 5-XP32-SP09-02	131	60	217	31.5				
ZD04-32. 0-XP32-SP09-02	133	60	219	32				
ZD04-32. 5-XP32-SP09-02	135	60	221	32.5				
ZD04-33. 0-XP32-SP09-02	137	60	223	33				
ZD04-33. 5-XP32-SP09-02	139	60	225	33.5				
ZD04-34. 0-XP32-SP11-02	141	60	227	34				
ZD04-34. 5-XP32-SP11-02	143	60	229	34.5				
ZD04-35. 0-XP32-SP11-02	145	60	231	35				
ZD04-35. 5-XP32-SP11-02	147	60	233	35.5				
ZD04-36. 0-XP32-SP11-02	149	60	235	36	SPMG110408	M4X10	T15	
ZD04-36. 5-XP32-SP11-02	151	60	237	36.5				
ZD04-37. 0-XP32-SP11-02	153	60	239	37				
ZD04-37. 5-XP32-SP11-02	155	60	241	37.5				
ZD04-38. 0-XP32-SP11-02	157	60	243	38				
ZD04-38. 5-XP32-SP11-02	159	60	245	38.5				
ZD04-39. 0-XP32-SP11-02	161	60	247	39				
ZD04-39. 5-XP32-SP11-02	163	60	249	39.5				
ZD04-40. 0-XP32-SP11-02	165	60	251	40				

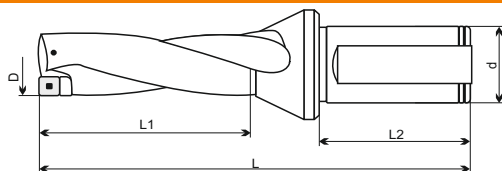

Модель	L1	L2	L	D	d	Применяемая пластина	Винт	Ключ
ZD05-13. 0-XP25-SP05-02	70	56	143	13	25	SPMG050204	H2X5	T6
ZD05-13. 5-XP25-SP05-02	72.5	56	145	13.5				
ZD05-14. 0-XP25-SP05-02	75	56	148	14				
ZD05-14. 5-XP25-SP05-02	77.5	56	150	14.5				
ZD05-15. 0-XP25-SP05-02	80	56	153	15				
ZD05-15. 5-XP25-SP06-02	82.5	56	155	15.5				
ZD05-16. 0-XP25-SP06-02	85	56	158	16				
ZD05-16. 5-XP25-SP06-02	87.5	56	160	16.5				
ZD05-17. 0-XP25-SP06-02	90	56	163	17				
ZD05-17. 5-XP25-SP06-02	92.5	56	165	17.5				
ZD05-18. 0-XP25-SP06-02	95	56	168	18				
ZD05-18. 5-XP25-SP06-02	97.5	56	170	18.5				
ZD05-19. 0-XP25-SP06-02	100	56	173	19				
ZD05-19. 5-XP25-SP06-02	102.5	56	174	19.5				
ZD05-20. 0-XP25-SP06-02	105	56	179	20				
ZD05-20. 5-XP25-SP06-02	107.5	56	181	20.5				
ZD05-21. 0-XP25-SP06-02	110	56	184	21				
ZD05-21. 5-XP25-SP06-02	112.5	56	186	21.5				
ZD05-22. 0-XP25-SP07-02	115	56	189	22				
ZD05-22. 5-XP25-SP07-02	117.5	56	193	22.5				
ZD05-23. 0-XP25-SP07-02	120	56	194	23				
ZD05-23. 5-XP25-SP07-02	122.5	56	196	23.5				
ZD05-24. 0-XP25-SP07-02	125	56	199	24				
ZD05-24. 5-XP25-SP07-02	127.5	56	201	24.5				
ZD05-25. 0-XP32-SP07-02	130	60	216	25				
ZD05-25. 5-XP32-SP07-02	132.5	60	218	25.5				
ZD05-26. 0-XP32-SP07-02	135	60	221	26				
ZD05-26. 5-XP32-SP07-02	137.5	60	223	26.5				
ZD05-27. 0-XP32-SP07-02	140	60	226	27				
ZD05-27. 5-XP32-SP07-02	142.5	60	228	27.5				
ZD05-28. 0-XP32-SP09-02	145	60	231	28				
ZD05-28. 5-XP32-SP09-02	147.5	60	233	28.5				
ZD05-29. 0-XP32-SP09-02	150	60	236	29				
ZD05-29. 5-XP32-SP09-02	152.5	60	238	29.5				
ZD05-30. 0-XP32-SP09-02	155	60	241	30				
ZD05-30. 5-XP32-SP09-02	157.5	60	243	30.5				
ZD05-31. 0-XP32-SP09-02	160	60	246	31				
ZD05-31. 5-XP32-SP09-02	162.5	60	248	31.5				
ZD05-32. 0-XP32-SP09-02	165	60	251	32				
ZD05-32. 5-XP32-SP09-02	167.5	60	253	32.5				
ZD05-33. 0-XP32-SP09-02	170	60	256	33				
ZD05-33. 5-XP32-SP09-02	172.5	60	258	33.5				
ZD05-34. 0-XP32-SP11-02	175	60	261	34				
ZD05-34. 5-XP32-SP11-02	177.5	60	263	34.5				
ZD05-35. 0-XP32-SP11-02	180	60	266	35				
ZD05-35. 5-XP32-SP11-02	182.5	60	268	35.5				
ZD05-36. 0-XP32-SP11-02	185	60	271	36				
ZD05-36. 5-XP32-SP11-02	187.5	60	273	36.5				
ZD05-37. 0-XP32-SP11-02	190	60	276	37				
ZD05-37. 5-XP32-SP11-02	192.5	60	278	37.5				
ZD05-38. 0-XP32-SP11-02	195	60	281	38				
ZD05-38. 5-XP32-SP11-02	197.5	60	283	38.5				
ZD05-39. 0-XP32-SP11-02	200	60	284	39				
ZD05-39. 5-XP32-SP11-02	202.5	60	288	39.5				
ZD05-40. 0-XP32-SP11-02	205	60	291	40				
					32	SPMG07T308	M2. 5X6	T8
						SPMG090408	И3. 5X8	T15
					SPMG110408	M4X10		

Модель	L1	L2	L	D	d	Применяемая пластина	Винт	Ключ
ZD04-41. 0-XP32-SP14-02	169	60	255	41	32	SPMG140512	M5X10	T20
ZD04-42. 0-XP32-SP14-02	173	60	259	42				
ZD04-43. 0-XP40-SP14-02	177	65	272	43				
ZD04-44. 0-XP40-SP14-02	181	65	276	44				
ZD04-45. 0-XP40-SP14-02	185	65	280	45				
ZD04-46. 0-XP40-SP14-02	189	65	284	46				
ZD04-47. 0-XP40-SP14-02	193	65	288	47				
ZD04-48. 0-XP40-SP07-04	197	65	292	48				
ZD04-49. 0-XP40-SP07-04	201	65	296	49				
ZD04-50. 0-XP40-SP07-04	205	65	300	50				
ZD04-51. 0-XP40-SP07-04	209	65	304	51	40	SPMG07T308	M2. 5X6	T8
ZD04-52. 0-XP40-SP09-04	213	65	308	52				
ZD04-53. 0-XP40-SP09-04	217	65	312	53				
ZD04-54. 0-XP40-SP09-04	221	65	316	54				
ZD04-55. 0-XP40-SP09-04	225	65	320	55				
ZD04-56. 0-XP40-SP09-04	229	65	324	56		SPMG090408	M3. 5X8	T15
ZD04-57. 0-XP40-SP09-04	233	65	328	57				
ZD04-58. 0-XP40-SP09-04	237	65	332	58				
ZD04-59. 0-XP40-SP09-04	241	65	336	59				
ZD04-60. 0-XP40-SP09-04	245	65	340	60				

Модель	L1	L2	L	D	d	Применяемая пластина	Винт	Ключ
ZD05-41. 0-XP32-SP14-02	210	60	296	41	32	SMG140512	M5X10	T20
ZD05-42. 0-XP32-SP14-02	215	60	301	42				
ZD05-43. 0-XP40-SP14-02	220	65	315	43				
ZD05-44. 0-XP40-SP14-02	225	65	320	44				
ZD05-45. 0-XP40-SP14-02	230	65	325	45				
ZD05-46. 0-XP40-SP14-02	235	65	330	46				
ZD05-47. 0-XP40-SP14-02	240	65	335	47				
ZD05-48. 0-XP40-SP07-04	245	65	340	48				
ZD05-49. 0-XP40-SP07 -04	250	65	345	49				
ZD05-50. 0-XP40-SP07- 04	255	65	350	50				
ZD05-51. 0-XP40-SP07-04	260	65	355	51	40	SPMG07T308	M2. 5X6	T8
ZD05-52. 0-XP40-SP09-04	265	65	360	52				
ZD05-53. 0-XP40-SP09-04	270	65	365	53				
ZD05-54. 0-XP40-SP09-04	275	65	370	54				
ZD05-55. 0-XP40-SP09-04	280	65	375	55				
ZD05-56. 0-XP40-SP09-04	285	65	380	56		SPMG090408	M3.5X8	T15
ZD05-57. 0-XP40-SP09-04	290	65	385	57				
ZD05-58. 0-XP40-SP09-04	295	65	390	58				
ZD05-59. 0-XP40-SP09-04	300	65	395	59				
ZD05-60. 0-XP40-SP09-04	305	65	400	60				

Комбинированный инструмент

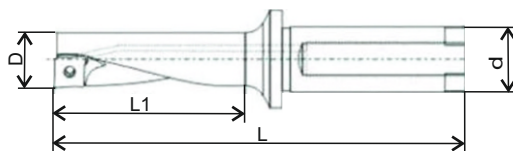
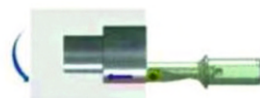
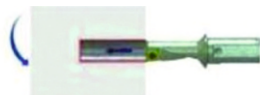
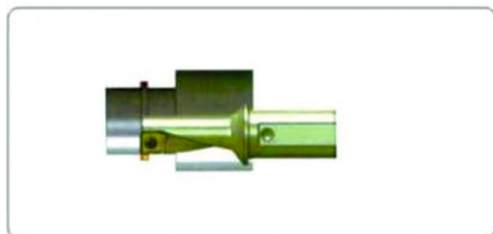
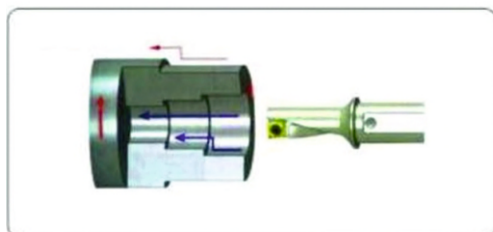

Модель	D	d	L1	L	Применяемая пластина	Винт	Ключ
TCAP-08R/L-3 ODN	8	12	24	75	XCMT 04 01 04	M1,8X3,5	T6
TCAP-09R/L-3 ODN	9	12	27	83	XCMT05 02 04	M2X5	T6
TCAP-10R/L-3 ODN	10	12	30	85	XCMT 05 02 04	M2X5	T6
TCAP-11R/L-3.0DN	11	16	33	92	XCMT 06 02 04	M2,2X5	T6
TCAP-12R/L-3.0DN	12	16	36	95	XCMT 06 02 04	M2,2X5	T6
TCAP-13R/L-3.0DN	13	16	39	100	XCMT 07 03 04	M2,5X6,5	T8
TCAP-14R/L-3 ODN	14	16	42	101	XCMT 07 03 04	M2,5X6,5	T8
TCAP-08R/L-2 25DN	8	12	18	69	XCMT 04 01 04	M2,5X6,5	T6
TCAP-09R/L-2.25DN	9	12	20 5	76	XCMT 05 02 04	M2X5	T6
TCAP-10R/L-2.25DN	10	12	22 5	78	XCMT 05 02 04	M2X5	T6
TCAP-11R/L-2 2 SDN	11	16	25	84	XCMT 06 02 04	M2,2X5	T6
TCAP-12R/L-2 25DN	12	16	27	86	XCMT 06 02 04	M2,2X5	T6
TCAP-13R/L-2.25DN	13	16	29 5	91	XCMT 07 03 04	M2,5X6,5	T8
TCAP*14R7L'2.25DN	14	16	31 5	91	XCMT 07 03 04	M2,5X6,5	T8

Оправки для внутреннего подвода СОЖ



Размеры

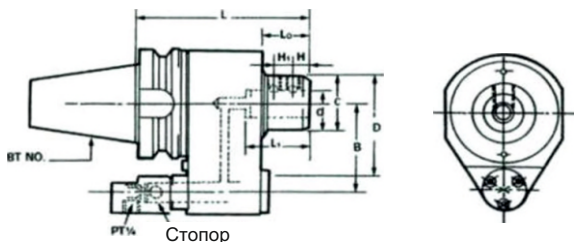

Модель	d	L	B	C	D	LO	L1	H	H1
BT40-OSL32-155	32	155	60/65	53	90	50	60	15	15
BT40-OSL40-155	40	155	60/65	70	90	50	70	19	18
BT50-OSL32-160	32	160	80/82	54	100	50	60	15	15
BT50-OSL40-160	40	160	80/82	64	100	50	70	19	18

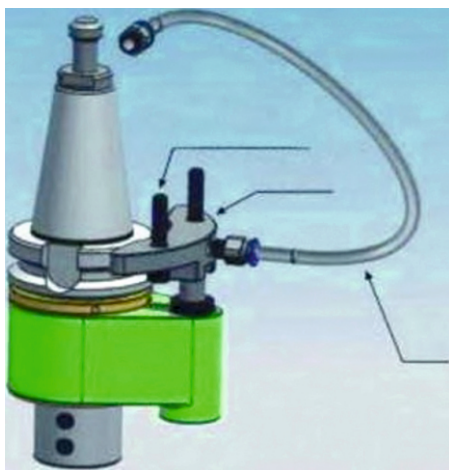
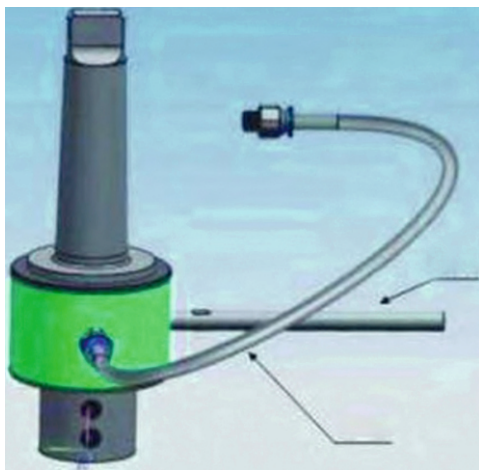

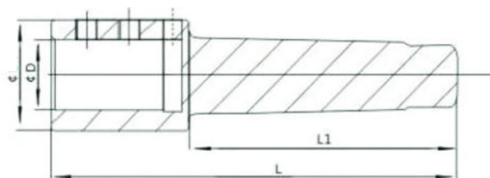

Модель	mm			
	D	D1	L	L1
DIN228-B-32-MTA4	32	64	204	124
DIN228-B-40-MTA4	40	64	204	124
DIN228-B-32-MTA5	32	64	204	156
DIN228-B-40-MTA5	40	64	204	156
DIN228-B-32-MTA6	32	64	303	218
DIN228-B-40-MTA6	40	64	303	218
DIN228-B-50-MTA6	50	74	303	218

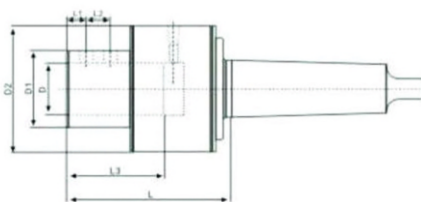
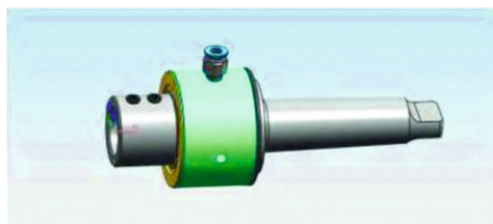

Модель	mm						
	D1	D2	D	L	L1	L2	L3
MT5-YLDB-32	32	55	92	127	15	18	60
MT5-YLDB-40	40	60	98	127	15	18	65
MT6-YLDB-32	32	55	92	127	15	18	60
MT6-YLDB-40	40	60	98	127	15	18	65
MT6-YLDB-50	50	70	108	127	15	18	70

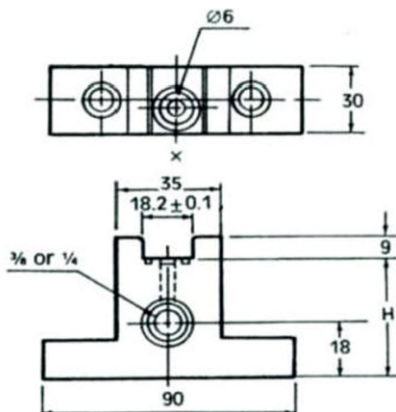

Картриджи

Диаметры	Осевой каридж	Переферийный каридж	Применяемая пластина	Кол-во пластин на катридже	Винт	Ключ
45-50	VNC-045050N	VMC-045050T	WCMX030204	2	TSB-22045	T6
50-55	VNC-050055N	VMC-050055T				
55-60	VNC-055060N	VMC-055060T	WCMX040204	2	TSB-25055	T10
60-65	VNC-060065N	VMC-060065T				
65-70	VNC-065070N	VMC-065070T	WCMX050308	2	TSB-30070	T15
70-75	VNC-070075N	VMC-070075T				
75-80	VNC-075080N	VMC-075080T	WCMX06T308	2	TSB-35090	T15
80-85	VNC-080085N	VMC-080085T				
85-90	VNC-085090N	VMC-085090T	WCMX06T308	2	TSB-35090	T15
90-95	VNC-090095N	VMC-090095T				
95-100	VNC-095100N	VMC-095100T	WCMX050308	3	TSB-30070	T10
100-105	VNC-100105N	VMC-100105T				
105-110	VNC-105110N	VMC-105110T	WCMX06T308	3	TSB-35090	T15
110-115	VNC-110115N	VMC-110115T				
115-120	VNC-115120N	VMC-115120T	WCMX06T308	3	TSB-35090	T15
120-125	VNC-120125N	VMC-120125T				
125-130	VNC-125130N	VMC-125130T	WCMX080408	3	TSB-40110	T15
130-135	VNC-130135N	VMC-130135T				
135-140	VNC-135140N	VMC-135140T	WCMX080408	3	TSB-40110	T15
140-150	VNC-140150N	VMC-140150T				
150-160	VNC-150160N	VMC-150160T	WCMX080408	3	TSB-40110	T15
160-170	VNC-160170N	VMC-160170T				
170-180	VNC-170180N	VMC-170180T	WCMX080408	3	TSB-40110	T15

Головки буров

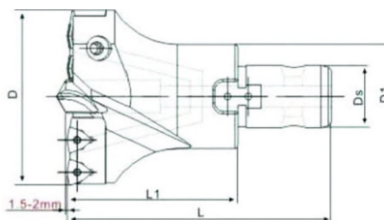

Бур	D	Ds	D1	Центральное	LI	L	Комплект катриджей	Пластина	Винт	Ключ
VMD-045050	45-50	16	30	PLS-1035 TiN-H	60	95	VMC-045050 N/T	WCMX030204	TSB-25055	T8
VMD-050055	50-55						VMC-050055 N/T			
VMD-055060	55-60	25	45	PLS-123S TiN-H	82	127	VMC-055060 N/T	WCMX040204	TSB-30070	T15
VMD-060065	60-65						VMC-060065 N/T			
VMD-065070	65-70	30	50	PLS-1645	139	154	VMC-065070 N/T	WCMX06T308	TSB-35090	T15
VMD-070075	70-75						VMC-070075 N/T			
VMD-075080	75-80	32	58	PLS-2045 TiN-H	94	154	VMC-075080 N/T	WCMX050308	TSB-30070	T8
VMD-080085	80-85						VMC-080085 N/T			
VMD-085090	85-90	40	70	PLS-2556 TiN-H	104	176	VMC-085090 N/T	WCMX06T308	TSB-35090	T15
VMD-090095	90-95						VMC-090095 N/T			
VMD-095100	95-100	50	80	PLS-2556 TiN-H	116	176	VMC-095100 N/T	WCMX080408	TSB-40110	T15
VMD-100105	100-105						VMC-100105 N/T			
VMD-105110	105-110	40	70	PLS-2556 TiN-H	116	176	VMC-105110 N/T	WCMX06T308	TSB-35090	T15
VMD-110115	110-115						VMC-110115 N/T			
VMD-115120	115-120	50	80	PLS-2556 TiN-H	116	176	VMC-115120 N/T	WCMX080408	TSB-40110	T15
VMD-120125	120-125						VMC-120125 N/T			
VMD-125130	125-130	50	80	PLS-2556 TiN-H	116	176	VMC-125130 N/T	WCMX080408	TSB-40110	T15
VMD-130135	130-135						VMC-130135 N/T			
VMD-135140	135-140	50	80	PLS-2556 TiN-H	116	176	VMC-135140 N/T	WCMX080408	TSB-40110	T15
VMD-140145	140-145						VMC-140145 N/T			
VMD-145150	145-150	50	80	PLS-2556 TiN-H	116	176	VMC-145150 N/T	WCMX080408	TSB-40110	T15
VMD-150155	150-155						VMC-150155 N/T			
VMD-155160	155-160	50	80	PLS-2556 TiN-H	116	176	VMC-155160 N/T	WCMX080408	TSB-40110	T15
VMD-160165	160-165						VMC-160165 N/T			
VMD-165170	165-170	50	80	PLS-2556 TiN-H	116	176	VMC-165170 N/T	WCMX080408	TSB-40110	T15
VMD-170175	170-175						VMC-170175 N/T			
VMD-175180	175-180	50	80	PLS-2556 TiN-H	116	176	VMC-175180 N/T	WCMX080408	TSB-40110	T15
							VMC-175180 N/T			

Удлинитель



Модель	D	D1	D2	L	L1	M	Диаметры при которых применяется
DXZ-3016100	30	16	32	100	75	MЮХ1	45-55
DXZ-3013150	30	16	32	150	75	MЮХ1	
DXZ-3016200	30	16	32	200	75	MЮХ1	
DXZ-3016250	30	16	32	250	75	MЮХ1	
DXZ-3016300	30	16	32	300	75	MЮХ1	
DXZ-3016400	30	16	32	400	75	MЮХ1	
DXZ-4525100	45	25	40	100	75	MЮХ1	60-80
DXZ-4525150	45	25	40	150	75	MЮХ1	
DXZ-4525200	45	25	40	200	75	MЮХ1	
DXZ-4525250	45	25	40	250	75	MЮХ1	
DXZ-4525300	45	25	40	300	75	MЮХ1	
DXZ-4525400	45	25	40	400	75	MЮХ1	
DXZ-5030100	50	30	40	100	75	M12X1	85-95
DXZ-5030150	50	30	40	150	75	M12X1	
DXZ-5030200	50	30	40	200	75	M12X1	
DXZ-5030250	50	30	40	250	75	M12X1	
DXZ-5030300	50	30	40	300	75	M12X1	
DXZ-5030400	50	30	40	400	75	M12X1	
DXZ-5832100	58	32	40	100	75	M12X1	100-110
DXZ-5832150	58	32	40	150	75	M12X1	
DXZ-5832200	58	32	40	200	75	M12X1	
DXZ-5832250	58	32	40	250	75	M12X1	
DXZ-5832300	58	32	40	300	75	M12X1	
DXZ-5832400	58	32	40	400	75	M12X1	
DXZ-7040100	70	40	50	100	80	M12X1	115-135
DXZ-7040150	70	40	50	150	80	M12X1	
DXZ-7040200	70	40	50	200	80	M12X1	
DXZ-7040250	70	40	50	250	80	M12X1	
DXZ-7040300	70	40	50	300	80	M12X1	
DXZ-7040400	70	40	50	400	80	M12X1	
DXZ-8050100	80	50	50	100	80	M12X1	140-195
DXZ-8050150	80	50	50	150	80	M12X1	
DXZ-8050200	80	50	50	200	80	M12X1	
DXZ-8050250	80	50	50	250	80	M12X1	
DXZ-8050300	80	50	50	300	80	M12X1	
DXZ-8050400	80	50	50	400	80	M12X1	

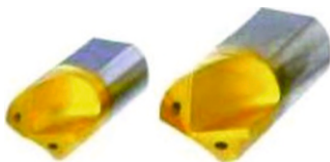
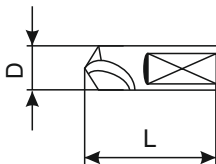

Центральное сверло	D	L
PLS-V1035 TIN-H	10	35
PLS-V1238 TIN-H	12	38
PLS-V1645 TIN-H	16	45
PLS-2045TIN-H	20	
PLS-2556 TIN-H	25	56
PLS-3068 TIN-H	30	68