

# 01

NC-TYPE

## LC-NC

- NC선반에 적합한 라이브센터
- 절삭유 및 이물질 유입 방지
- 3중 베어링 구조로 정밀도가 높고 수명이 길다
- SHAFT 열처리 경도 HRC58~62
- RUN OUT 0.003

- Live Center for CNC lathe
- Prevent the inflow of cutting oil and foreign substance
- High degree of accuracy of rotation and high durability by using the triplexed bearing structure as high degree of precision
- Heat treatment hardness of Shaft : HRc58-62
- RUN OUT 0.003



### NCB TYPE

바이트 간섭 최소화  
Minimize the bite-interference



### NCBC TYPE

바이트 간섭 최소화 / 초경타입  
Minimize the bite-interference / Carbide Type



### NCBN TYPE

바이트 간섭 최소화 / 너트타입  
Minimize the bite-interference / Nut Type



### NCBCN TYPE

바이트 간섭 최소화 / 초경, 너트 타입  
Minimize the bite-interference / Carbide, Nut Type



### NCC TYPE

초경타입  
Carbide Type

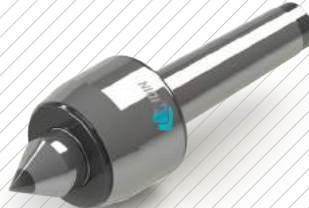

### NCN TYPE

너트타입  
Nut Type



### NCCN TYPE

초경, 너트타입  
Carbide, Nut Type



# NC-TYPE

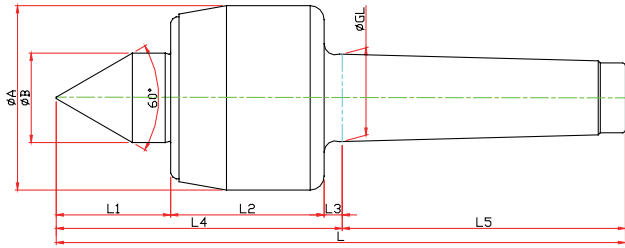

Model	Order Number	Morse Taper	Dimension										Weight MAX.	R.P.M MAX.	Run Out
			GL	A	B	L1	L2	L3	L4	L5	L				
LC-3NC	010003	NO.3	23.825	50	22	27	45	5	77	81	158	630	4800	0.003	
LC-4NC	010004	NO.4	31.267	66	32	41	55	6.5	102.5	101.5	204	1100	3800	0.003	
LC-5NC	010005	NO.5	44.399	82	40	50	65	6.5	121.5	129.5	251	1600	3400	0.005	
LC-6NC	010006	NO.6	63.384	105	45	54	80	8	142	182	324	2100	3000	0.005	

# NCB-TYPE

※ SHAFT 확장(바이트 간섭 최소화) SHAFT EXTENSION(Minimize the bite-interference)

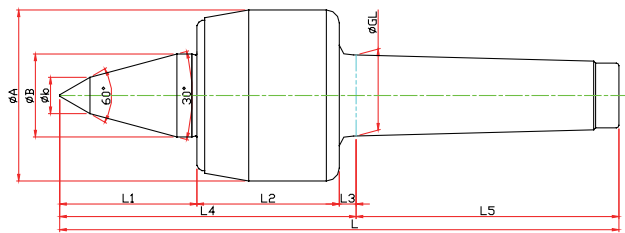

Model	Order Number	Morse Taper	Dimension										Weight MAX.	R.P.M MAX.	Run Out
			GL	A	B	b	L1	L2	L3	L4	L5	L			
LC-3NCB	011003	NO.3	23.825	50	22	10	47	45	5	97	81	178	280	4800	0.003
LC-4NCB	011004	NO.4	31.267	66	32	14	53	55	6.5	114.5	101.5	216	510	3800	0.003
LC-5NCB	011005	NO.5	44.399	82	40	16	65	65	6.5	129.5	129.5	266	750	3400	0.005
LC-6NCB	011006	NO.6	63.384	105	45	18	78	80	8	182	182	348	940	3000	0.005

# NCC-TYPE

※ 초경타입 Carbide Type

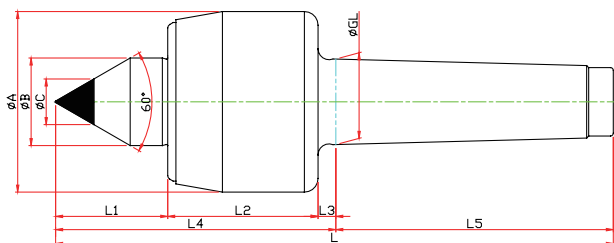

Model	Order Number	Morse Taper	Dimension										Weight MAX.	R.P.M MAX.	Run Out
			GL	A	B	L1	L2	L3	L4	L5	C	L			
LC-3NCC	010103	NO.3	23.825	50	22	27	45	5	77	81	10	158	630	4800	0.003
LC-4NCC	010104	NO.4	31.267	66	32	41	55	6.5	102.5	101.5	14	204	1100	3800	0.003
LC-5NCC	010105	NO.5	44.399	82	40	50	65	6.5	121.5	129.5	18	251	1600	3400	0.005
LC-6NCC	010106	NO.6	63.384	105	45	54	80	8	142	182	25	324	2100	3000	0.005

# NCBC-TYPE

- ※ SHAFT 확장(바이트 간섭 최소화) SHAFT EXTENTION(Minimize the bite-interference)
- ※ 초경타입 Carbide Type

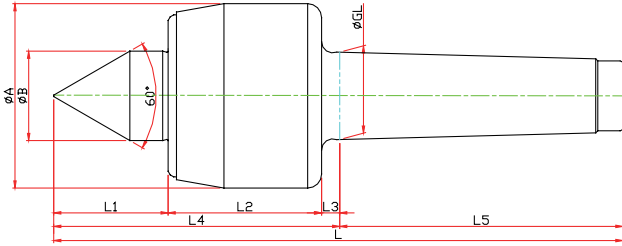

Model	Order Number	Morse Taper	Dimension										Weight MAX.	R.P.M MAX.	Run Out
			GL	A	B	L1	L2	L3	L4	L5	C	L			
LC-3NCBC	011102	NO.3	23,825	50	22	47	45	5	97	81	10	178	280	4800	0,003
LC-4NCBC	011103	NO.4	31,267	66	32	53	55	6.5	114.5	101.5	14	216	510	3800	0,003
LC-5NCBC	011104	NO.5	44,399	82	40	65	65	6.5	136.5	129.5	16	266	750	3400	0,005
LC-6NCBC	011105	NO.6	63,384	105	45	78	80	8	166	182	18	348	940	3000	0,005

# NCN-TYPE

- ※ 너트타입 Nut Type

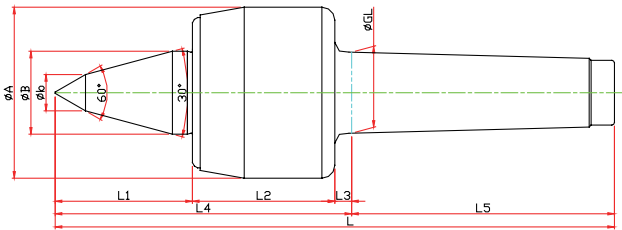

Model	Order Number	Morse Taper	Dimension										Weight MAX.	R.P.M MAX.	Run Out
			GL	A	B	L1	L2	L3	L4	L5	N	L			
LC-3NCN	010013	NO.3	23,825	50	22	27	45	5	77	81	70	158	630	4800	0,003
LC-4NCN	010014	NO.4	31,267	66	32	41	55	6.5	102.5	101.5	85	204	1100	3800	0,003
LC-5NCN	010015	NO.5	44,399	82	40	50	65	6.5	121.5	129.5	105	251	1600	3400	0,005
LC-6NCN	010016	NO.6	63,384	105	45	54	80	8	142	182	130	324	2100	3000	0,005

# NCBN-TYPE

- ※ SHAFT 확장(바이트 간섭 최소화) SHAFT EXTENTION(Minimize the bite-interference)
- ※ 너트타입 Nut Type

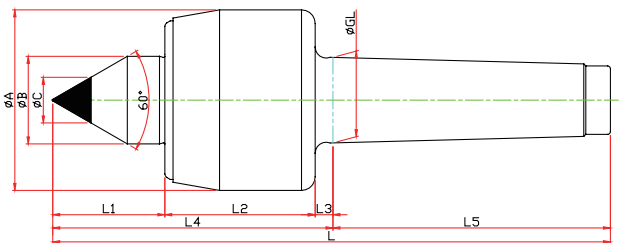

Model	Order Number	Morse Taper	Dimension											Weight MAX.	R.P.M MAX.	Run Out
			GL	A	B	b	L1	L2	L3	L4	L5	N	L			
LC-3NCBN	011013	NO.3	23,825	50	22	10	47	45	5	97	81	70	178	280	4800	0,003
LC-4NCBN	011014	NO.4	31,267	66	32	14	53	55	6.5	114.5	101.5	85	216	510	3800	0,003
LC-5NCBN	011015	NO.5	44,399	82	40	16	65	65	6.5	136.5	129.5	105	266	750	3400	0,005
LC-6NCBN	011016	NO.6	63,384	105	45	18	78	80	8	166	182	130	348	940	3000	0,005

# NCCN-TYPE

※ 너트, 초경타입 Nut, Carbide Type Type

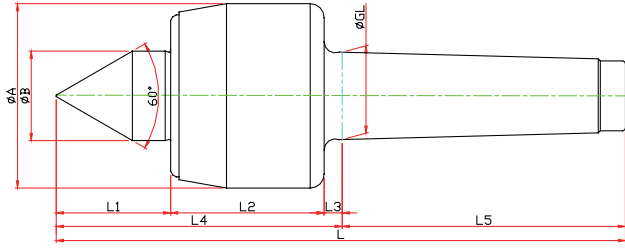

Model	Order Number	Morse Taper	Dimension											Weight MAX.	R.P.M MAX.	Run Out
			GL	A	B	L1	L2	L3	L4	L5	C	N	L			
LC-3NCCN	010113	NO.3	23,825	50	22	27	45	5	77	81	10	70	158	630	4800	0,003
LC-4NCCN	010114	NO.4	31,267	66	32	41	55	6.5	102.5	101.5	14	85	204	1100	3800	0,003
LC-5NCCN	010115	NO.5	44,399	82	40	50	65	6.5	121.5	129.5	18	105	251	1600	3400	0,005
LC-6NCCN	010116	NO.6	63,384	105	45	54	80	8	142	182	25	130	324	2100	3000	0,005

# NCBCN-TYPE

※ SHAFT 확장(바이트 간섭 최소화) SHAFT EXTENTION(Minimize the bite-interference)

※ 너트, 초경타입 Nut, Carbide Type Type

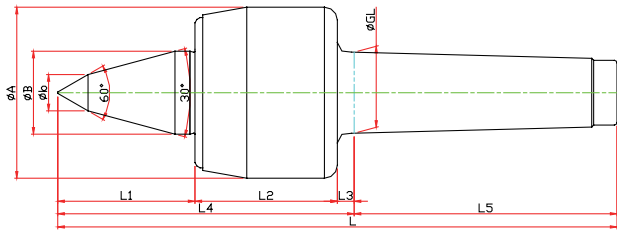

Model	Order Number	Morse Taper	Dimension											Weight MAX.	R.P.M MAX.	Run Out
			GL	A	B	L1	L2	L3	L4	L5	C	N	L			
LC-3NCBCN	011113	NO.3	23,825	50	22	47	45	5	97	81	10	70	178	280	4800	0,003
LC-4NCBCN	011114	NO.4	31,267	66	32	53	55	6.5	114.5	101.5	14	85	216	510	3800	0,003
LC-5NCBCN	011115	NO.5	44,399	82	40	65	65	6.5	136.5	129.5	16	105	266	750	3400	0,005
LC-6NCBCN	011116	NO.6	63,384	105	45	78	80	8	166	182	18	130	348	940	3000	0,005

# NC-SPECIAL

※ 사용자의 조건에 따라 주문, 제작 Customized-special production for user's condition



NC-TYPE

NCP-TYPE

NK·NKD TYPE

GR·SM TYPE

SMP-TYPE

D50 TYPE

HD-TYPE

PT-TYPE

LM CENTER

LM-H CENTER