



WISE

Samchully vises are integral solutions for various applications. Our power vises are featured with a torque setter to ensure high repeatability and durability.

Whether used on a machine table, jig or even on a custom machine, our vise line is an added value to your production.



SPV

Serration type
Power Vise

222 P



FV

Flexible Vise

234 P



CMV-R

Self centering
5-Axis Vise

223 P



VS

Standard
Machine Vise

236 P



CMV-S

Self centering
5-Axis Vise

224 P



MMV

Mechanical
Machine Quick Vise

238 P



PCV

Standard
Power Vise

226 P



APV

Air Vise

240 P



PSV

Short Type
Power Vise

228 P



PLV

Long Stroke Type
Power Vise

230 P



DDV

Draw Down Type
Power Vise

232 P



MDV

Double Power Vise

233 P

SPV Serration type Power Vise

Jaw Width Range : 160mm
Max. Opening Range : 300mm



Application / Benefits

Serration type for easy Jaw setting(Pitch=3.0mm)

Technical features

Minimal jaw set-up times

Sealed cover prevents swarf contamination

SPECIFICATIONS

	SPV-156
Jaw Width [mm]	160
Jaw Height [mm]	115
Max. Opening [mm]	300
Total Height [mm]	175
Slider Height [mm]	115
Total Width [mm]	161
Total Length [mm]	595.5
Max.Gripping Force [kN(kgf)]	60(6100)
Weight [kg]	73

※ Specifications are subject to change without notice.

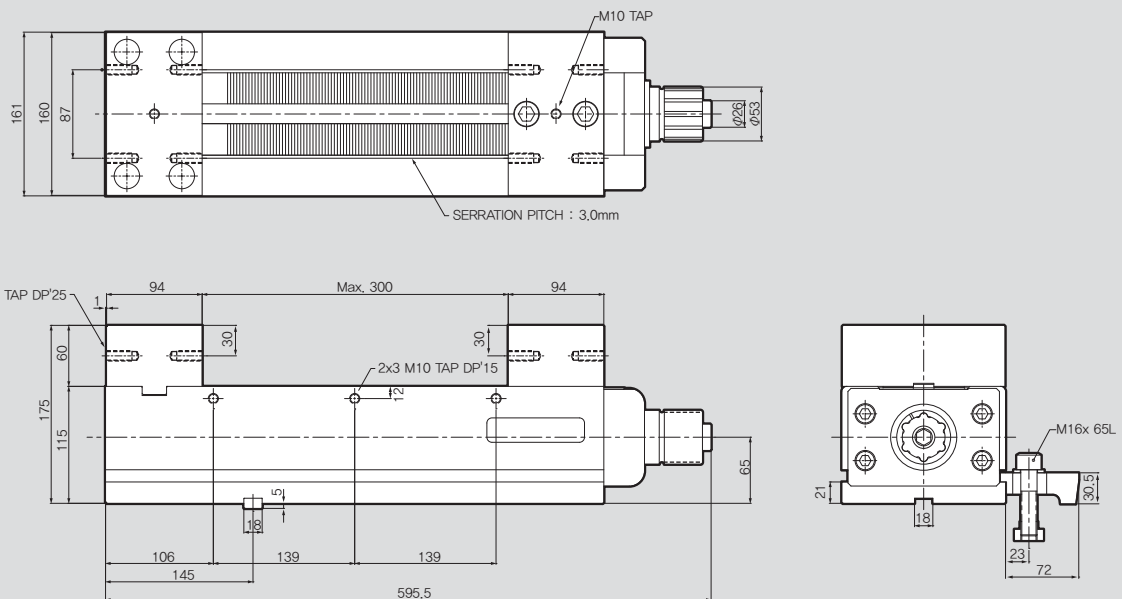

CMV-R 5-Axis Centering Vise

Jaw Width Range : 125mm
Max. Opening Range : 125mm



Application / Benefits

Self centering 5-Axis vise

Technical features

Repeats within 0.02mm or lower. Uses 1.5 pitch serration jaws
Able to use a variety of jaws for various workpieces

SPECIFICATIONS

	CMV-125R
Jaw Width [mm]	125
Jaw Height [mm]	20
Max. Opening [mm]	125
Total Height [mm]	125
Slider Height [mm]	80
Total Width [mm]	125
Total Length [mm]	Ø 200
Max.Gripping Force [kN(kgf)]	20(2000)
Weight [kg]	17

※ Specifications are subject to change without notice.

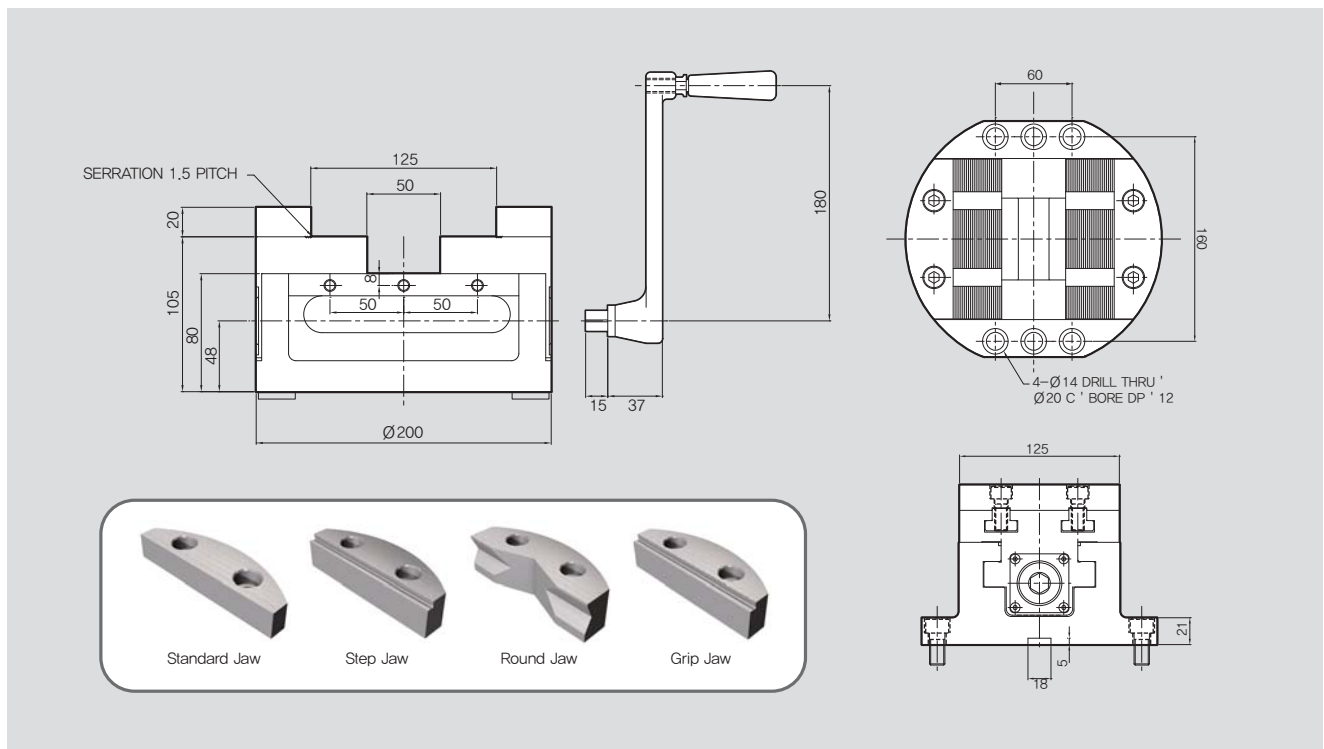

CMV-S 5-Axis Centering Vise



Application / Benefits

Self centering 5-Axis vise

Technical features

Repeats within 0.02mm or lower

Able to use a variety of jaws for various workpieces

SPECIFICATIONS

	CMV-100S	CMV-125S
Jaw Width [mm]	100	125
Jaw Height [mm]	10	10
Max. Opening [mm]	195	210
Total Height [mm]	160	185
Slider Height [mm]	150	175
Total Width [mm]	101	126
Total Length [mm]	285	332
Max.Gripping Force [kN(kgf)]	20(2000)	20(2000)
Weight [kg]	18	24

※ Specifications are subject to change without notice.

JAW ACCESSORIES

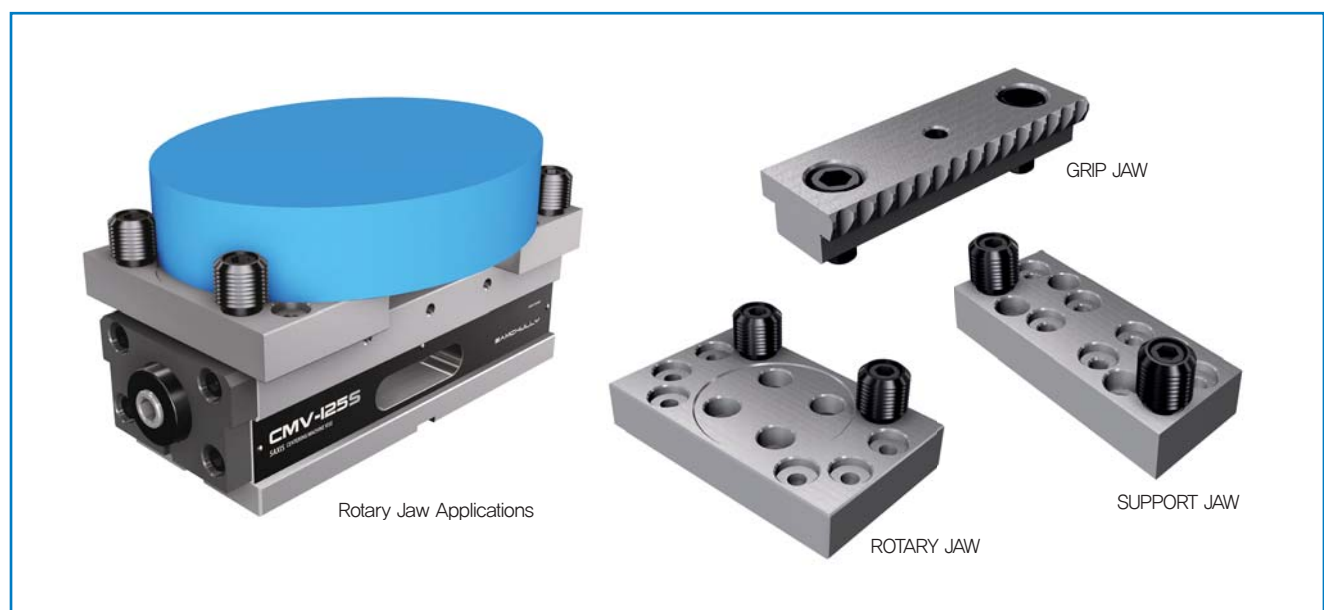

Jaw Width Range : 100~125mm
 Max. Opening Range : 200~210mm

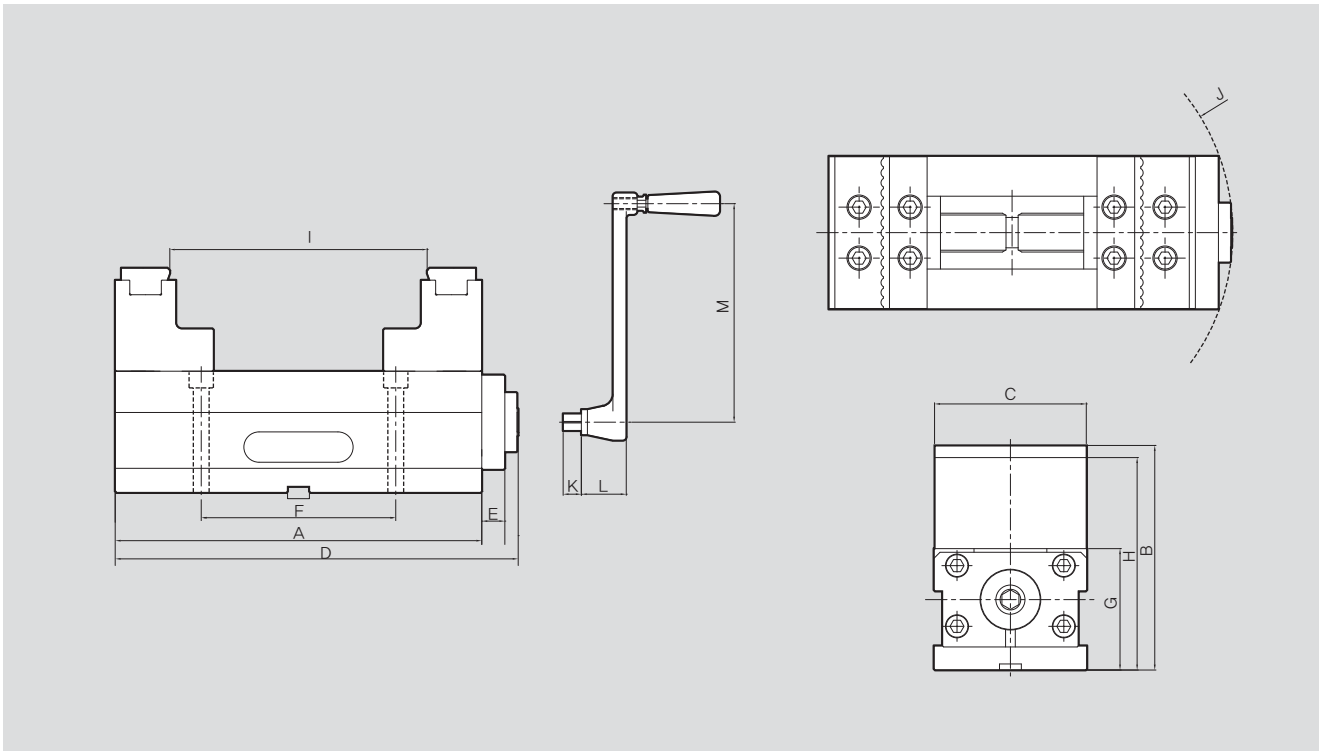

DIMENSIONS

	CMV-100S	CMV-125S
A	262	301
B	160	185
C	100	125
D	285	332
E	12	19
F	160	160
G	85	100
H	150	175
I	MAX. 195	MAX. 210
J	Φ310	Φ364
K	15	15
L	37	37
M	180	180

PCV Standard Power Vise



Application / Benefits

High precision vise with torque presetter

Technical features

Mechanically boosted torque presetter helps prevent part deformation

SPECIFICATIONS

	PCV-100 (4")	PCV-125 (5")	PCV-160 (6")	PCV-200 (8")	PCV-250 (10")
Jaw Width [mm]	100	125	160	200	250
Jaw Height [mm]	40	50	60	70	80
Max. Opening [mm]	150	230	300	320	450
Total Height [mm]	115	135	160	180	195
Slider Height [mm]	75	85	100	110	115
Total Width [mm]	107	135	170	214	264
Total Length [mm]	400	505	595	638	810
Max.Gripping Force [kN(kgf)]	25(2551)	35(3571)	60(6122)	60(6122)	80(8163)
Weight [kg]	25	43	65	100	150

※ Specifications are subject to change without notice.

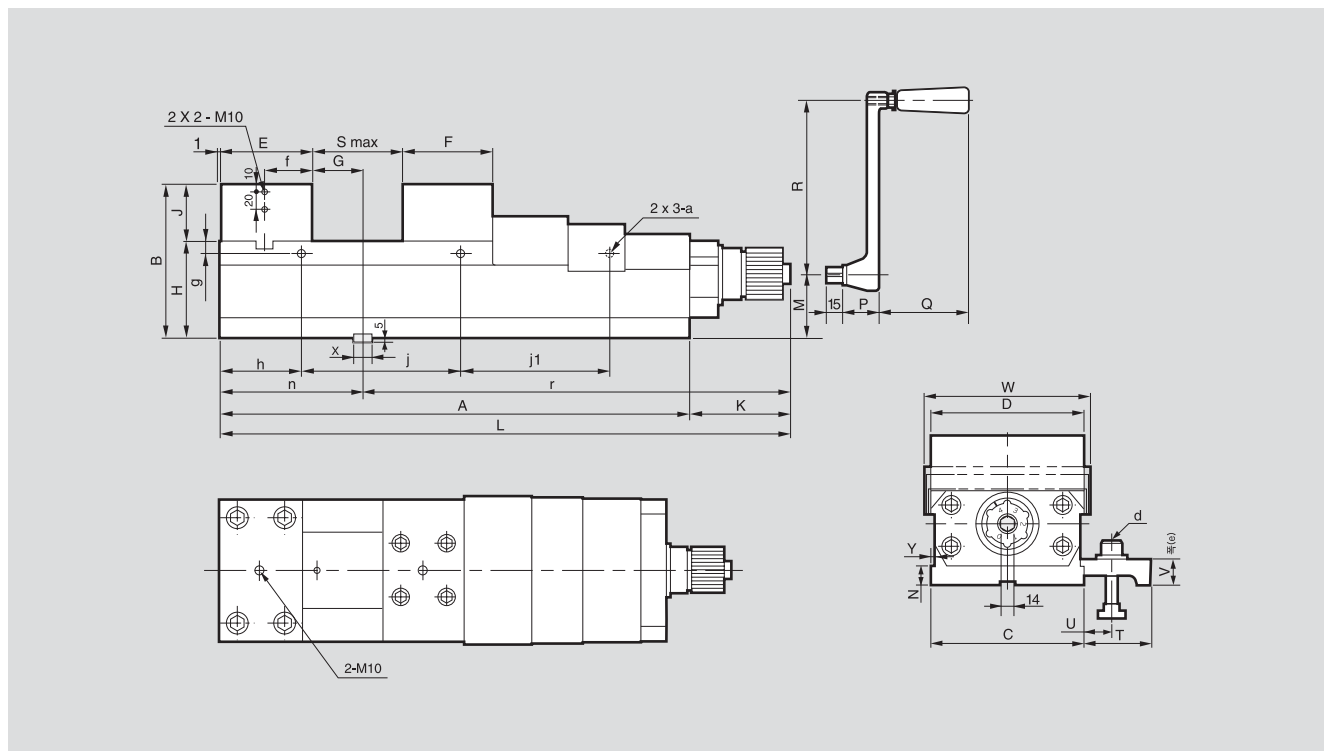

※ See the product dimension Table on the right.

DIMENSIONS

	PCV-100(4")	PCV-125(5")	PCV-160(6")	PCV-200(8")	PCV-250(10")
A	295	400	490	533	705
B	115	135	160	180	195
C	101	126	161	202	252
D	100	125	160	200	250
E	73	84	94	102	120
F	64	76	86	98	120
G	38.5	60	50	74	100
H	75	85	100	110	115
J	40	50	60	70	80
K	105.5	105.5	105.5	105.5	105.5
L	400.5	505.5	595.5	638.5	810.5
M	43	50	65	75	75
N	15	21	21	21	21
P	37	37	37	37	37
Q	95	95	95	95	95
R	180	180	180	180	180
S	150	230	300	320	450
T	60	72	72	72	72
U	14~26	15~31	15~31	15~31	15~31
V	22.5	30	30	30	30
W	107	135	170	214	267
X	14	18	18	18	22
Y	6	6	7	7	7
a	M10	M10	M10	M10	M10
b	M12x45	M16x65	M16x65	M16x65	M20x65
e	35	45	45	45	45
f	36.5	42	47	51	60
g	12	12	12	12	12
h	95	95	105	126	140
j	105	105	140	141	140
j1	-	105	140	141	140
j2	-	-	-	-	140
n	112.5	145	145	177	221
r	288.0	360.5	450.5	461.5	589.5

PSV Short-Type Power Vise



Application / Benefits

High precision vise with torque presetter
Suitable for a wide range of workpiece sizes

Technical features

Mechanically boosted torque presetter helps prevent part deformation

SPECIFICATIONS

	PSV-125(5")	PSV-160(6")
Jaw Width [mm]	125	160
Jaw Height [mm]	50	60
Max. Opening [mm]	125	160
Total Height [mm]	135	160
Slider Height [mm]	85	100
Total Width [mm]	135	170
Total Length [mm]	400.5	455.5
Max.Gripping Force [kN(kgf)]	35(3571)	60(6122)
Weight [kg]	41	62

※ Specifications are subject to change without notice.

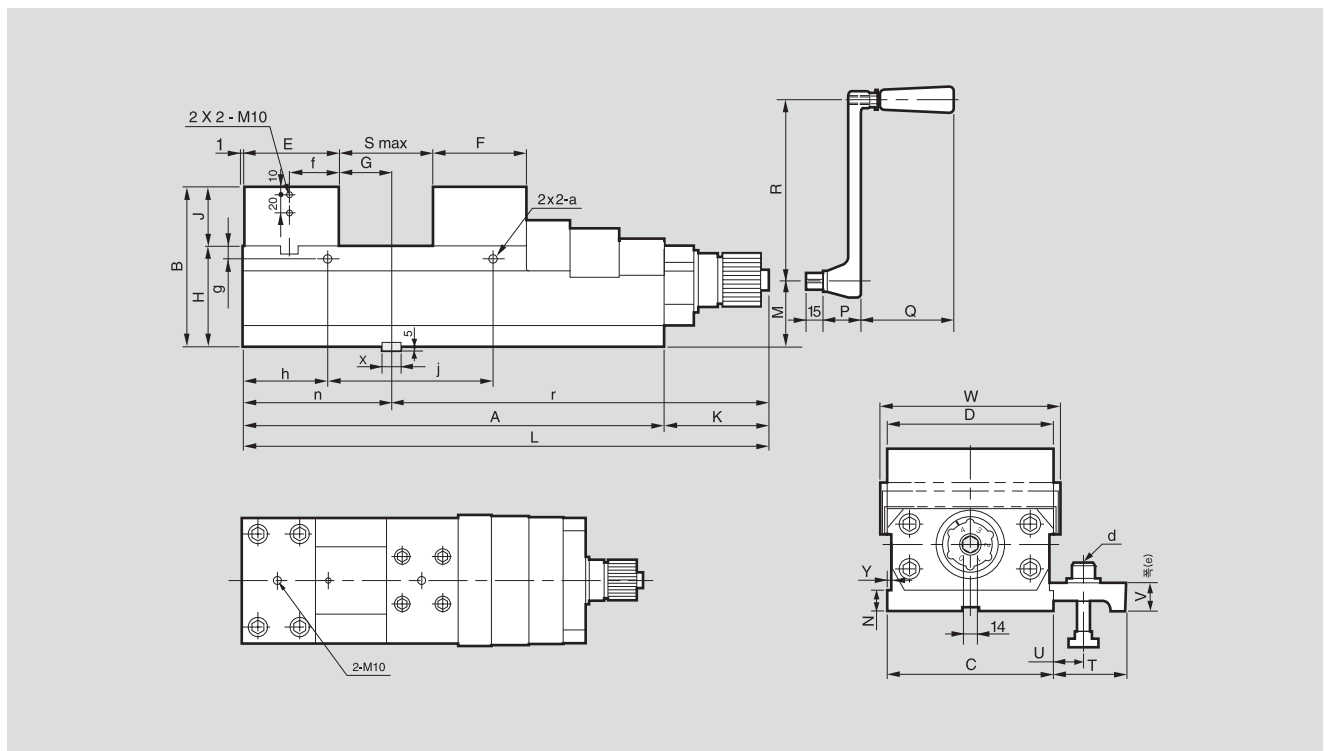

※ See the product dimension Table on the right.

DIMENSIONS

	PSV-125(5")	PSV-160(6")
A	295	350
B	135	160
C	126	161
D	125	160
E	84	94
F	76	86
G	60	50
H	85	100
J	50	60
K	105.5	105.5
L	400.5	455.5
M	50	65
N	21	21
P	37	37
Q	95	95
R	180	180
S	125	160
T	72	72
U	15~31	15~31
V	30	30
W	135	170
X	18	18
Y	6	7
a	M10	M10
b	M16x65	M16x65
e	45	45
f	42	47
g	12	12
h	95	105
j	105	140
j1	105	140
n	145	145
r	150	450.5

PLV Long Stroke Power Vise



Application / Benefits

High precision vise with torque presetter
Suitable for a wide range of workpiece sizes

Technical features

Mechanically boosted torque presetter helps prevent part deformation

SPECIFICATIONS

	PLV-125(5")	PLV-160(6")	PLV-200(8")
Jaw Width [mm]	125	160	200
Jaw Height [mm]	50	60	70
Max. Opening [mm]	230	354	405
Total Height [mm]	135	160	180
Slider Height [mm]	85	100	110
Total Width [mm]	135	170	214
Total Length [mm]	700.5	647.5	723.5
Max.Gripping Force [kN(kgf)]	35(3571)	60(6122)	60(6122)
Weight [kg]	47	70	110

※ Specifications are subject to change without notice.

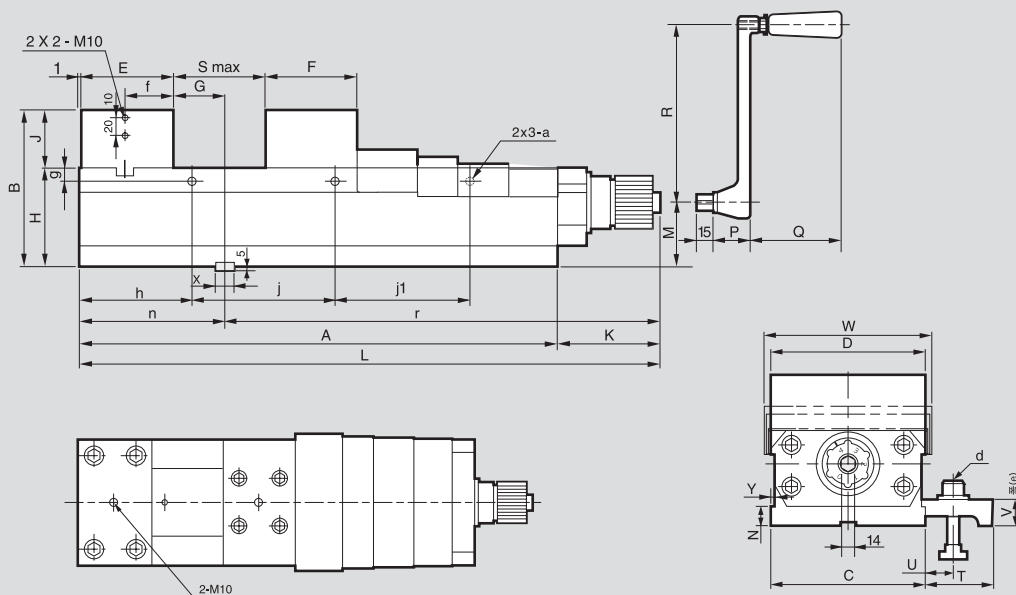

※ See the product dimension Table on the right.

DIMENSIONS

	PLV-125(5")	PLV-160(6")	PLV-200(8")
A	595	542	618
B	135	160	180
C	126	161	202
D	125	160	200
E	84	94	102
F	76	86	98
G	60	82	74
H	85	100	110
J	50	60	70
K	105.5	105.5	105.5
L	700.5	647.5	723.5
M	50	65	75
N	21	21	21
P	37	37	37
Q	95	95	95
R	180	180	180
S max	230	354	405
T	72	72	72
U	15-31	15-31	15-31
V	30	30	30
W	135	170	214
X	18	18	18
Y	6	7	7
a	M10	M10	M10
b	M16x65	M16x65	M16x65
e	45	45	45
f	42	47	51
g	12	12	12
h	95	117	126
j	202.5	150	183
j1	202.5	150	183
n	280	177	177
r	360.5	470.5	546.5

DDV Draw-Down Type Power Vise

Jaw Width Range : 160mm
Max. Opening Range : 248mm



Application / Benefits

Draw down function reduces workpiece floating

Technical features

Mechanically boosted torque presetter helps prevent part deformation (with Special Jaws)

SPECIFICATIONS

	Jaw Width [mm]	Jaw Height [mm]	Maw. Opening [mm]	Total Opening [mm]	Slider Height [mm]	Total Width [mm]	Total Length [mm]	Max. Gripping Force [kN(kgf)]	Weight [kg]
DDV-160(6'')	160	60	248	160	100	170	595	60(6122)	70

※ Specifications are subject to change without notice.

DIMENSIONS

	A	B	C	D	E	F	G	H	J	J1	J2	K	L	M	N	P	Q
DDV-160(6'')	490	160	161	160	120	112	24	100	60	105.5	595.5	65	21	37	95	180	248
	T	U	V	W	X	Y	a	b	e	f	g	h	j	j1	n	r	
	72	15~31	30	170	18	7	M10	M16x65	45	47	12	105	140	140	145	450.5	

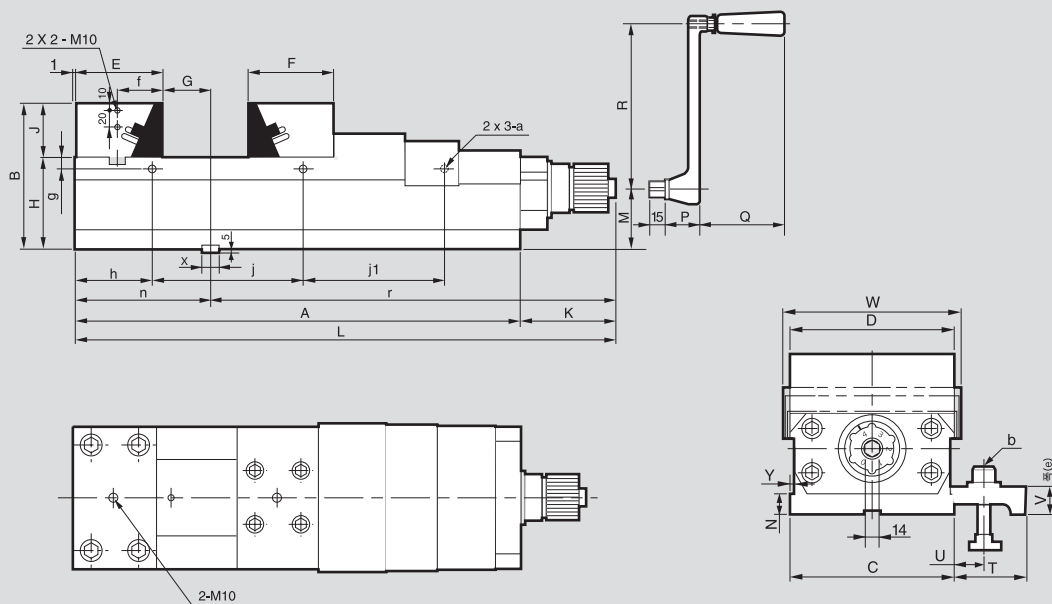

MDV Double Power Vise

Jaw Width Range : 125mm
Max. Opening Range : 141~190.5mm



Application / Benefits

Clamps two workpieces simultaneously.

Technical features

Mechanically boosted torque presetter helps prevent part deformation.
3mm compensations facilitates loading and mitigates workpiece variance.

SPECIFICATIONS

	Jaw Width [mm]	Jaw Height [mm]	Max. Opening [mm]				Total Opening [mm]	Slider Height [mm]	Total Width [mm]	Total Length [mm]	Max. Gripping Force [kN(kgf)]	Weight [kg]
MDV-125	125	40	S1	S2	S3	S4	145	105	126	671	40(4355)	52
			141	144.5	187	190.5						

※ Specifications are subject to change without notice.

DIMENSIONS

	A	B	C	D	E	F	G	H	J	J1	J2	K	L	M	N	P	Q	R	T
MDV-125	495	145	126	125	40	75	-	105	40	20	45	176	671	50	15	37	94	180	72
	U	V	W	X	Y	a	d	e	f	g	h	j	n	r	t	y	z	z1	w
	15~31	30.5	126	18	6	M10	M16x65L	42	37	20	205	90	250	421	355	98	11	17.5	10

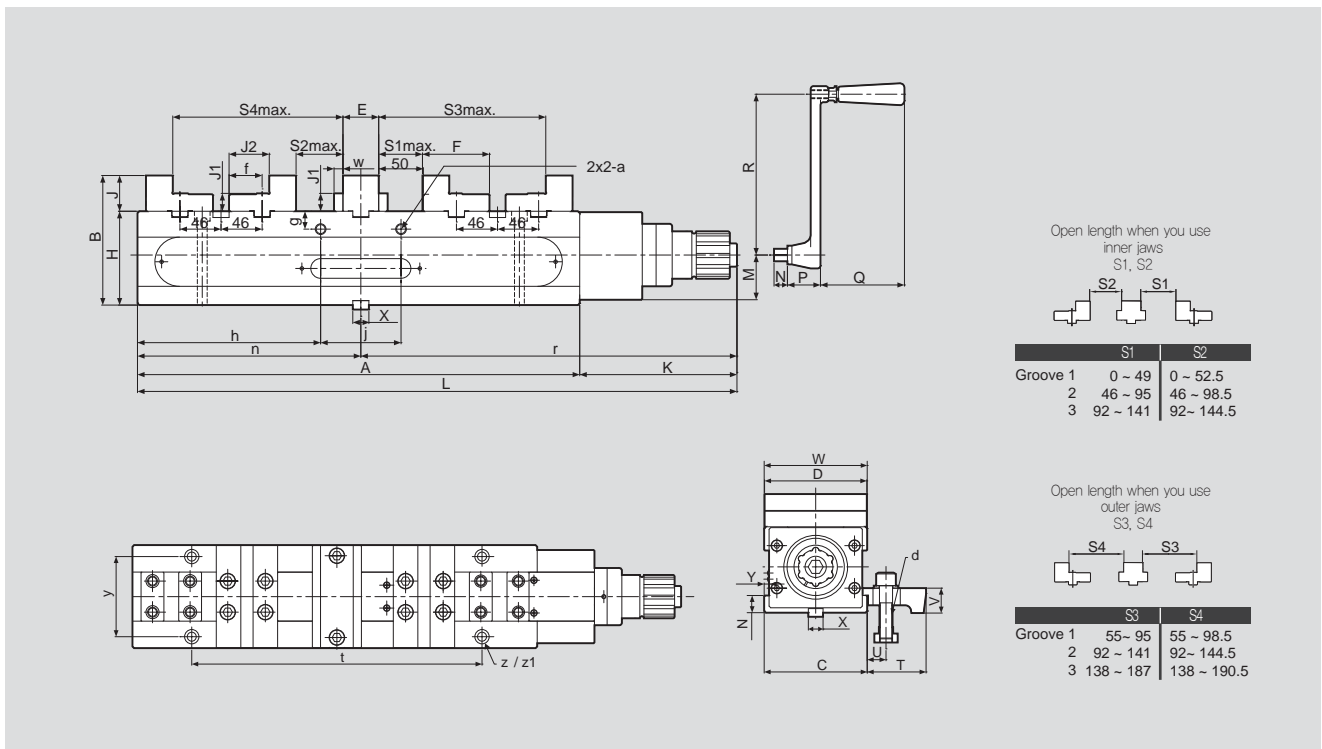



Application / Benefits

Multi clamping.

Technical features

Serrated jaws may be repositioned. Minimizes deformation.

SPECIFICATIONS

	Jaw Width [mm]	Jaw Height [mm]	Maw. Opening [mm]				Total Opening [mm]	Slider Height [mm]	Total Width [mm]	Total Length [mm]	Max. Gripping Force [kN(kgf)]	Weight [kg]
FV5060	50	25	S1	S2	S3	S4	75	50	50	600	-	15
			500	215	120	75						

※ Specifications are subject to change without notice.

DIMENSIONS

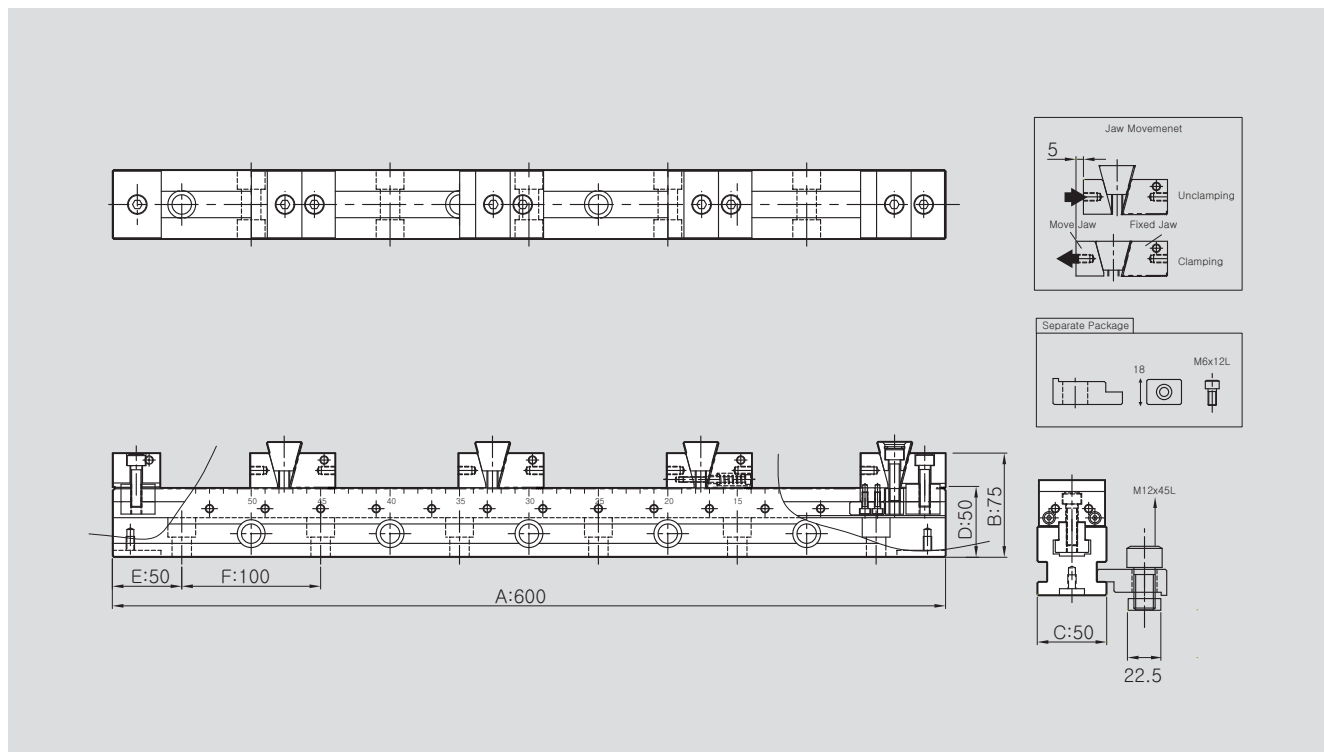

※ See the product dimension Table on the right.

CLAMPING RANGE

1EA Clamping

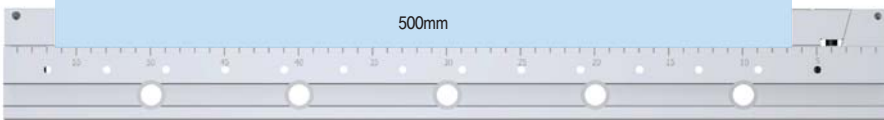

2EA Clamping

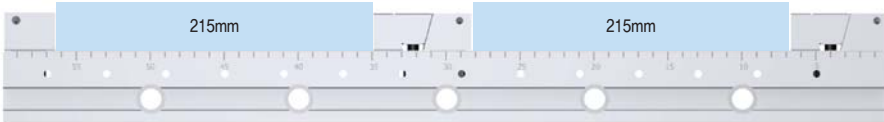

3EA Clamping

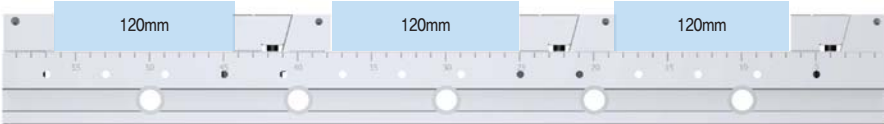

4EA Clamping

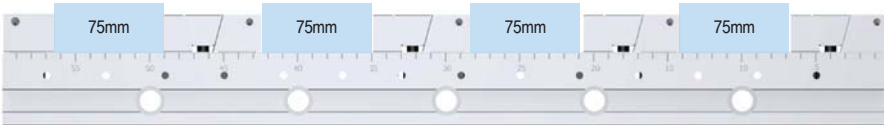

Max. Clamping Range



VS Standard Machine Vise



Application / Benefits

High precision machine vise

Technical features

Special hardened material used

SPECIFICATIONS

	VS-150(6")	VS-175(7")	VS-200(8")	VS-250(10")
Body [kg]	34	46.7	57.5	110
Table [kg]	10.8	14.5	20.5	36.5
Max. Opening [mm]	110	132	160	199
Operating Swivel Base	SB-150T	SB-175T	SB-200T	SB-250T
Mounting Key Size	34x16x10	34x16x10	36x20x12	36x20x12

※ Specifications are subject to change without notice.

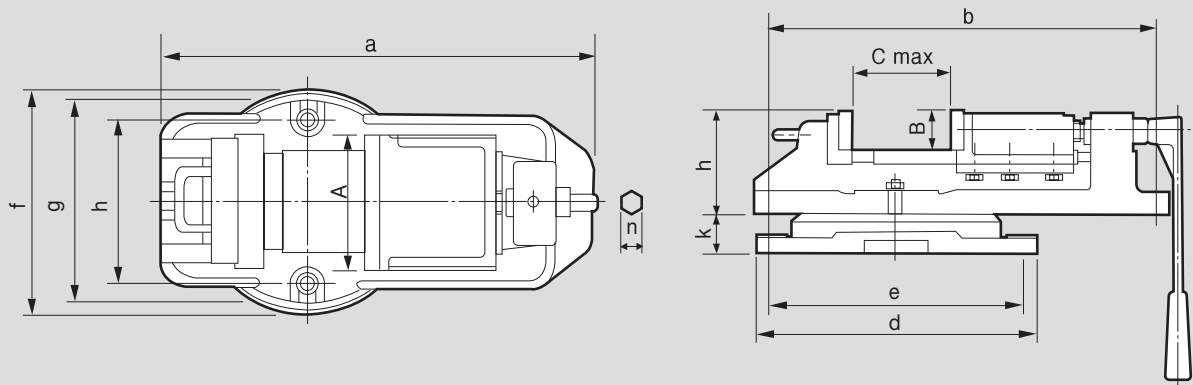

※ See the product dimension Table on the right.

DIMENSIONS

	VS-150(6")	VS-175(7")	VS-200(8")	VS-250(10")
A	150	175	200	250
B	45	50	55	75
C	110	132	160	199
a	470	547	618	760
b	440	518	573	716
c	320	350	400	450
d	288	318	358	406
e	245	280	316	370
f	220	245	280	332
g	180	198	228	278
h	115	120	130	168
i	45	50	55	60
j	283	340	340	380
k	18	21	21	22

MMV Mechanical Machine Quick Vise



Application / Benefits

Mechanical Machine Vise with no oil leak.

Technical features

Mechanically boosted torque presetter helps prevent part deformation

SPECIFICATIONS

	MMV-150Q(6")	MMV-200Q(8")
Max. Grip Torque [kg]	4,400	6,500
Body [kg]	56.0	94.0
Max. Opening [mm]	300	300
Table [kg]	16.0	23.0
Operating Swivel Base	VS-175T	VS-200T
Mounting Key Size	34x16x10	36x20x12

※ Specifications are subject to change without notice.

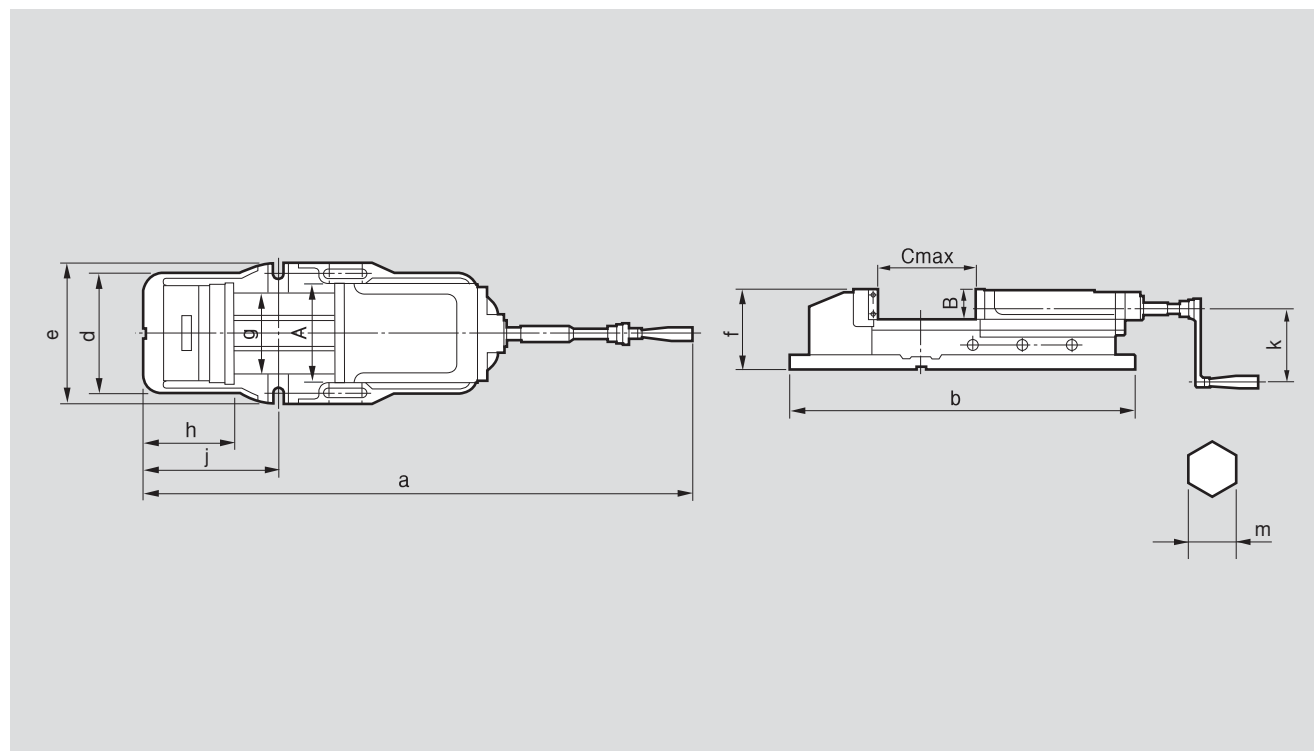

※ See the product dimension Table on the right.

DIMENSIONS

	MMV-150Q(6")	MMV-200Q(8")
A	150	200
B	51	62
C	300	300
a	800	900
b	620	700
c	200	240
d	240	280
e	133	162
g	116	160
h	125	165
i	210	266
j	130	130
k	19	19
Max. Grip Torque [kg]	4,400	6,500

APV Air Vise



Application / Benefits

Pneumatic clamping

Technical features

Control pressure with a dial

SPECIFICATIONS

	APV-125	APV-160
Jaw Width [mm]	125	160
Jaw Height [mm]	60	60
Max. Opening [mm]	188	165
Total Height [mm]	150	160
Slider Height [mm]	100	100
Total Width [mm]	166	199
Total Length [mm]	585	584
Max.Gripping Force [kN(kgf)]	35(3500)	60(6000)
Weight [kg]	55	63

※ Specifications are subject to change without notice.

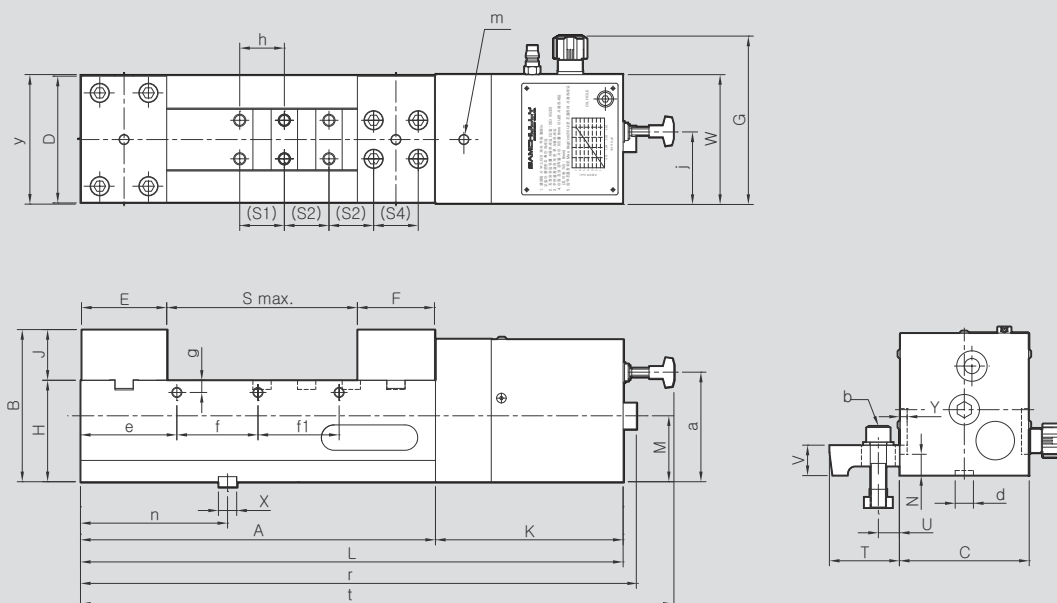

※ See the product dimension Table on the right.

DIMENSIONS

	APV-125	APV-160
A	350	350
B	150	160
C	128	161
D	125	160
E	84	94
F	76	86
G	166	199
H	100	100
J	50	60
K	185	185
L	535	535
M	65	65
N	21	21
S max	188	165
T	69	72
U	15~30	23
V	30	30.5
W	128	163.8
X	18	18
Y	7	7
a	108	97
b	M16X65L	M16X16L
d	18	18
e	95	105
f	80	140
g	12	12
h	44	50
j	71.5	100
n	145	145
r	548	548
t	585	584