

# SL Standard Slotter Chuck (Hard Jaws)

Thru Hole Range :  $\varnothing 60 \sim \varnothing 100$   
Clamping Range :  $\varnothing 4 \sim \varnothing 266$



## Application / Benefits

Low-profile and compact  
Ideal for machining centers

## Technical features

Angled t-handle slot  
One-piece, reversible hard jaws

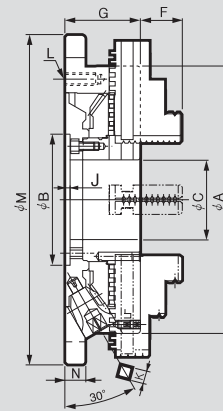
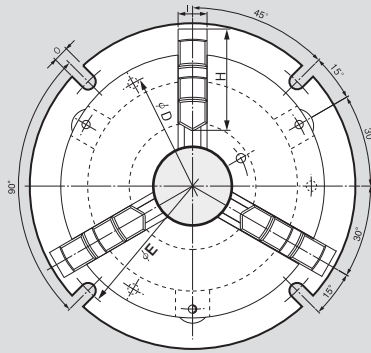

## DIMENSIONS

	SL-08	SL-10	SL-12
$\Phi A$	215	255	305
$\Phi B(HC6)$	110	125	160
$\Phi C$	60	76	100
$\Phi D$	190.5	230	280
$\Phi E$	240	286	340
F	35.04	40.02	45.05
G	64	72	76
H	85	98	110
I	25	28	30
J	4	4.5	5
K	11	12	14
L	M10	M12	M12
M	266	315	370
N	17	20	22
O	13	15	17

## SPECIFICATIONS

	SL-08	SL-10	SL-12
Max. Static Gripping Force [kN(kgf)]	37(3,800)	46(4,700)	55(5,620)
Clamping Range External [ $\phi$ mm]	4~182	4~220	5~266
Clamping Range Internal [ $\phi$ mm]	58~174	68~212	80~263
Handle Torque [N · m(kgf · m)]	117.7(13)	176.5(18)	196.2(20)
Weight [kg]	17.6	27.7	40

※ Maximum turning speed is based upon actual measurement.

# MCA Stationary Pneumatic Chuck



## Application / Benefits

Ideal for machining centers

## Technical features

Sealed against coolant and chips

Built-in air cylinder with compact design

## SPECIFICATIONS

	MCA-04	MCA-06	MCA-08	MCA-10
Clamping Force (Pneumatic 6bar) [kN(kgf)]	7.5(765)	21(2140)	33(3300)	48(4800)
Jaw Stroke Dia. [mm]	5.2	5.2	6.3	6.3
Grip Dia. Max [mm]	110	165	210	254
Grip Dia. Min [mm]	10	23	30	50
Max. Pneumatic Pressure [MPa(kgf/cm <sup>2</sup> )]	0.7(7)	0.7(7)	0.7(7)	0.7(7)
Weight [kg]	7.3	16	28	43

Thru Hole Range :  $\varnothing 20 \sim \varnothing 43$   
Clamping Range :  $\varnothing 10 \sim \varnothing 250$

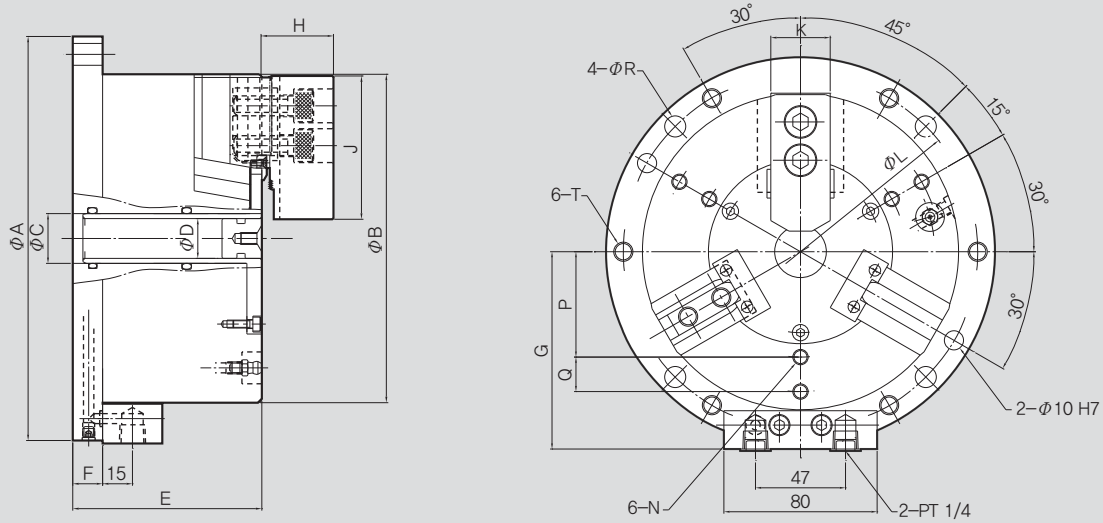

※ It is recommended to grease chucks at least twice a day in order to maximize longevity.

## DIMENSIONS

	MCA-04	MCA-06	MCA-08	MCA-10
ΦA	148	203	248	300
ΦB	110	165	210	254
ΦC	20	25	36	50
ΦD	-	20	30	43
E	90	95	106	110
F	15	15	15	16
G	75.5	103	125.5	147.5
H	27	36	42	46
J	55	72	95	110
K	23	31	35	40
N	M8	M8	M8	M10
ΦL(P.C.D)	130	185	230	280
P	-	55	68	80
Q	-	58	68	80
ΦR	9	11	11	13
T	M10	M10	M10	M12

# MCH Stationary Power Chuck



## Application / Benefits

Ideal for machining centers

## Technical features

Sealed against coolant and chips

Built-in hydraulic cylinder with compact design

## SPECIFICATIONS

	MCH-06	MCH-08	MCH-10
Clamping Force (25bar) [kN]	55	85	125
Jaw Stroke Dia. [mm]	5.2	6.3	6.8
Grip Dia. Max [mm]	169	210	254
Grip Dia. Min [mm]	15	30	50
Max. Pneumatic Pressure [MPa(kgf/cm <sup>2</sup> )]	3(30.5)	3(30.5)	3(30.5)
Weight [kg]	18	30	44

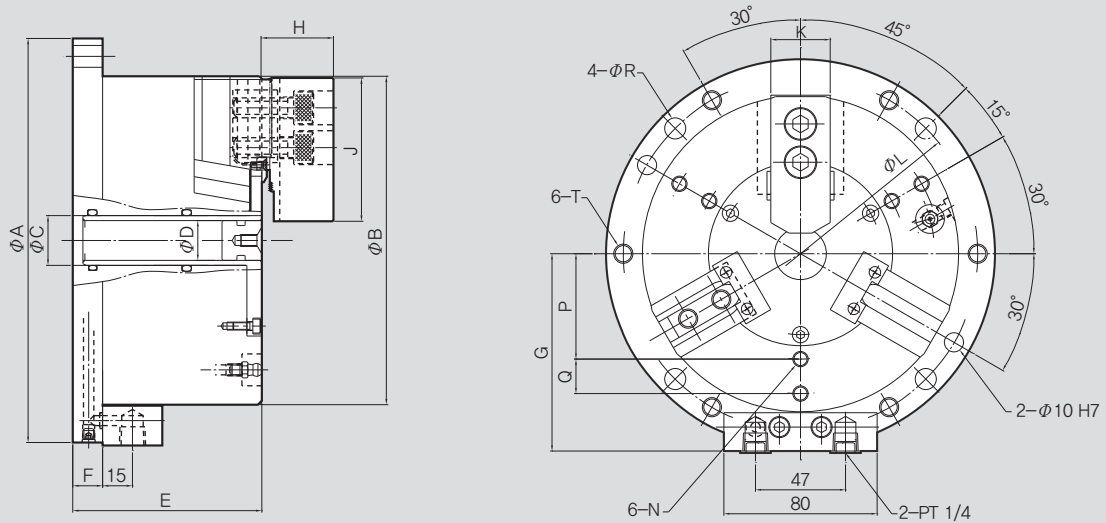

※ It is recommended to grease chucks at least twice a day in order to maximize longevity.

## DIMENSIONS

	MCH-06	MCH-08	MCH-10
ΦA	210	255	300
ΦB	165	210	254
ΦC	25	36	50
ΦD	20	30	43
E	100	111	121
F	20	20	20
G	103	125.5	147.5
H	36	42	46
J	72	95	110
K	31	35	40
N	M8	M8	M10
ΦL (P.C.D.)	185	235	280
P	55	68	80
Q	18	25	35
ΦR	11	11	13
T	M10	M10	M12