

SF 4-Jaw Scroll Chuck (Hard Jaws)

Thru Hole Range : $\varnothing 57 \sim \varnothing 100$
Clamping Range : $\varnothing 4 \sim \varnothing 300$



Application / Benefits

For square work requiring through hole

Technical features

Rear mounting only

One-piece reversible, hard jaws

Self-centering jaws manually opened and closed by t-handle

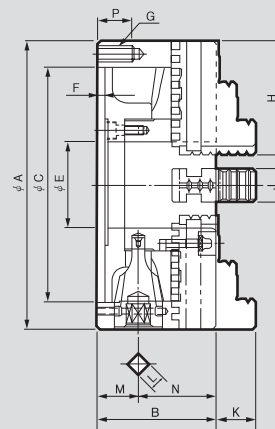
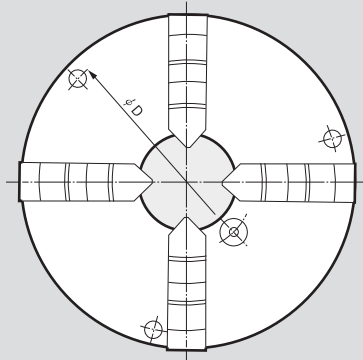

DIMENSIONS

	SF-190(7")	SF-230(9")	SF-273(10")	SF-310(12")	SF-405(16")
$\varnothing A$	192	232	273	310	405
B	75	84	86	96	114.5
$\varnothing C(H6)$	155	190	230	260	345
$\varnothing D$	172	210	250	285	375
$\varnothing E$	57	75	89	100	130
F	5	6	6	7	8
G	3-M10	3-M12	3-M12	3-M12	6-M12
H	75	85	98	110	133
J	22	24	28	30	35
K	30.06	35.04	40.02	45.08	63
L	11	12	12	14	15
M	27.5	29.5	31.5	31.5	42
N	47.5	54.5	54.5	64.5	72.5
P	20	25	25	25	36

SPECIFICATIONS

	SF-190(7")	SF-230(9")	SF-273(10")	SF-310(12")	SF-405(16")
Max. Static Gripping Force [kN(kgf)]	31(3161)	37(3773)	46(4691)	55(5608)	
Clamping Range External [ϕ mm]	4~180	5~220	5~260	10~300	
Clamping Range Internal [ϕ mm]	56~170	62~210	70~250	86~290	
Handle Torque [N · m(kgf · m)]	107.9(11.0)	147(15.0)	176.5(18.0)	206(21.0)	
Max. r.p.m. [min^{-1}]	3500	2900	2500	2200	
Weight [kg]	12.5	21.5	28	41	
Moment of inertia [N · m ² (kg · m ²)]	2.45(0.25)	6.37(0.65)	9.90(1.01)	23.0(2.35)	

※ Maximum turning speed is based upon actual measurement.