

# HSL 3-Jaw High-Speed Open Center Long-Stroke Chuck



## Application / Benefits

For work requiring longer stroke and through-hole

## Technical features

Wedge hook style chuck with high gripping force

## ACTUAL GRIPPING FORCE DIAGRAM

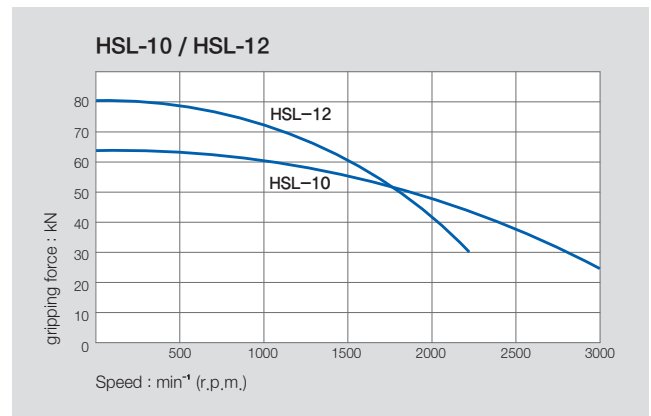
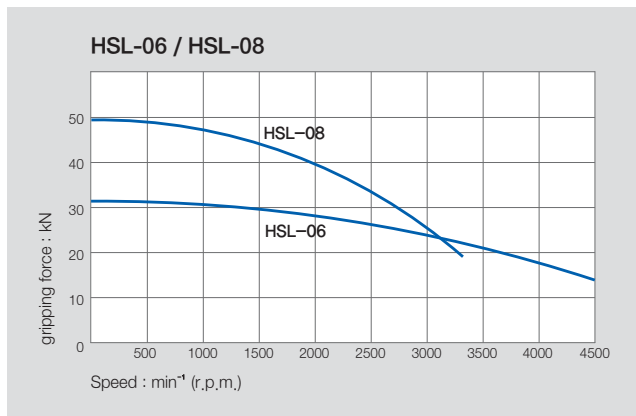

## SPECIFICATIONS

	HSL-06	HSL-08	HSL-10	HSL-12
Thru Hole Dia. [mm]	33	46	53	63
Grip Dia. Max [mm]	169	215	254	304
Grip Dia. Min [mm]	28	32	42	43
Jaw Stroke Dia. [mm]	20.2	25.4	30	36
Plunger Stroke [mm]	15	22	25	30
Max. Permissible Input Force [kN(kgf)]	27.9(2845)	41.1(4191)	53.8(5486)	69.3(7067)
Max. Static Gripping Force [kN(kgf)]	31.2(3182)	49.0(4997)	63.0(6427)	80.4(8199)
Max. r.p.m. [ $\text{min}^{-1}$ ]	4500	3300	3000	2200
Weight [kg]	14	25	45	78
Moment of inertia [ $\text{N} \cdot \text{m}^2(\text{kg} \cdot \text{m}^2)$ ]	1.67(0.17)	7.75(0.79)	12(1.2)	36(3.67)
Operating Cylinder	SH-13046 (SYH-1246)	SH-15052 (SYS-1552)	SH-18077 (SYH-1877)	SYH-2091
Max. Hydraulic Pressure [MPa(kgf/cm <sup>2</sup> )]	3.40(34.7)	2.99(30.5)	3.20(32.6)	3.22(32.8)
Operating Hard Jaw	HB06A1	HB08A1	HB10A1	HB12N1
KITAGAWA® Model	BL-206	BL-208	BL-210	BL-212

※ Specifications are subject to change without notice.

※ Samchully Machinery Co., Ltd. is no longer an OEM manufacturer for Kitagawa® Iron Works Co., Ltd.

Thru Hole Range :  $\varnothing 33 \sim \varnothing 63$   
 Clamping Range :  $\varnothing 28 \sim \varnothing 304$

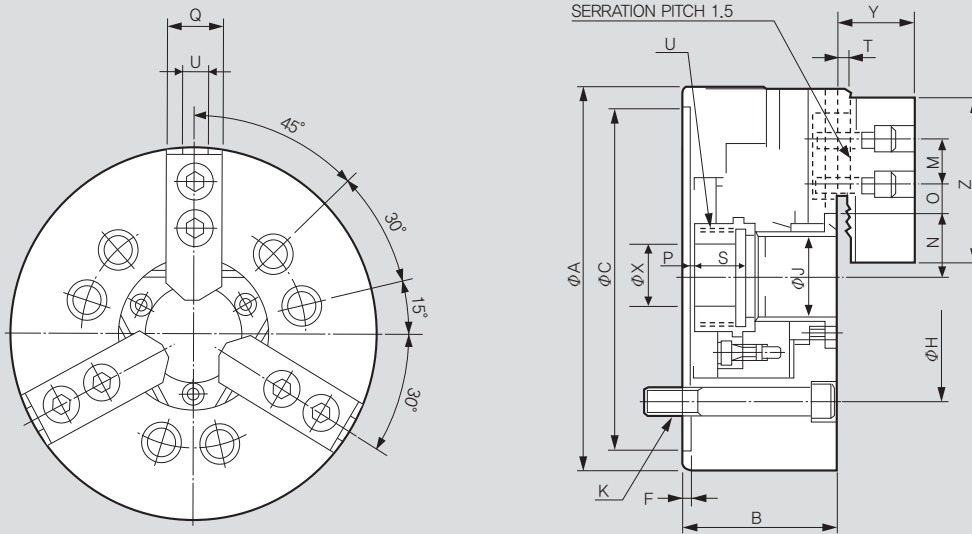

※ It is recommended to grease chucks at least twice a day in order to maximize longevity.

## DIMENSIONS

	HSL-06	HSL-08	HSL-10	HSL-12
$\varnothing A$	169	215	254	304
B	84	99	110	130
$\varnothing C(H6)$	140	170	220	220
F	5	5	5	6
$\varnothing H$	104.8	133.4	171.4	171.4
$\varnothing J$	33	46	53	63
K	6-M10	6-M10	6-M16	6-M16
M	20	25	30	30
N max.	39.3	52.3	62	72.4
N min.	29.2	39.6	46.9	54.4
O max.	16.75	20.7	26.2	38.2
O min.	9.25	11.5	9.7	8.2
P max.	14	15.5	14.5	15
P min.	-1	-6.5	-10.5	-15
Q	31	35	40	49
R	12	14	16	21
S	19	22.5	25	28
T	2	2	2	3
U max.	M42x1.5	M55x2.0	M65x2.0	M75x2.0
W	47	66	80	83
$\varnothing X$	20	30	45	50
Y	32.5	39	43	50.5
Z	72	95	110	111

※ Blank and machined draw-nuts are available.

### RELATED PRODUCT

